



EVERWOOD WPC-DECKING  
Ultima Decking  
Endura Decking  
Classic Decking



Installation Guide

**EVERWOOD**<sup>®</sup>  
EVERLASTING IMPRESSIONS

## DECKING PLANKS & TRIMS

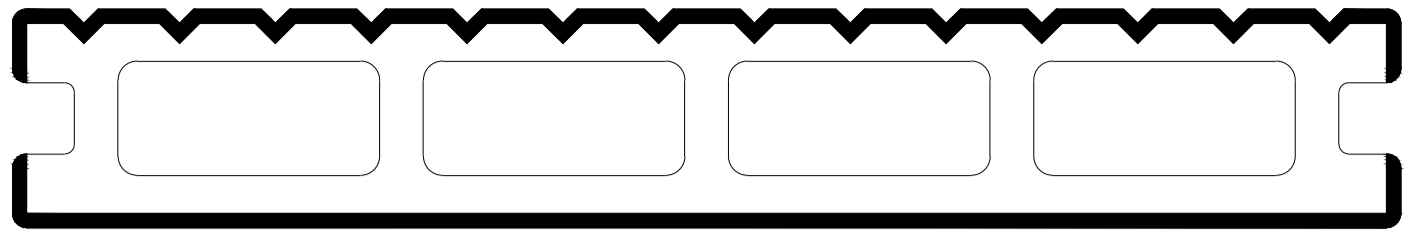

ULTIMA-EWD146X23

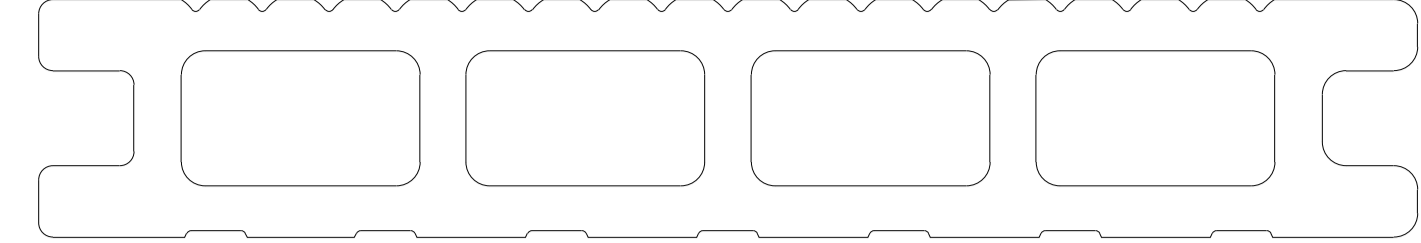

ENDURA-EWD145X25

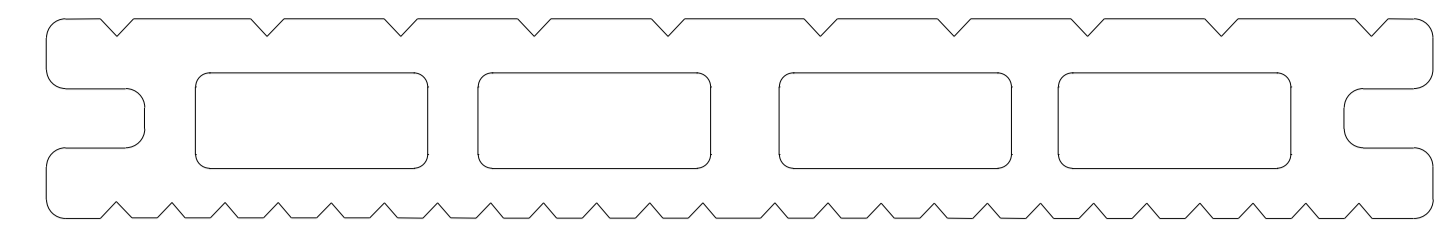

CLASSIC-EWD146X21

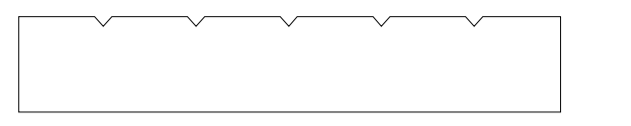

TRIM  
EWD57X10

## DECKING CLIPS

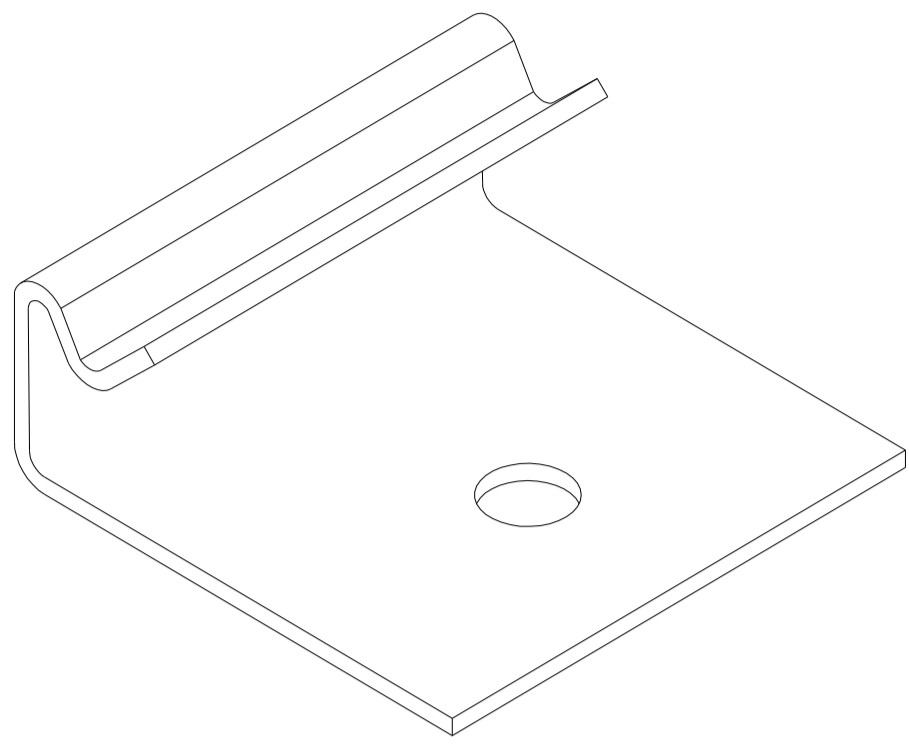

START CLIP  
CODE:EWD29X30SC

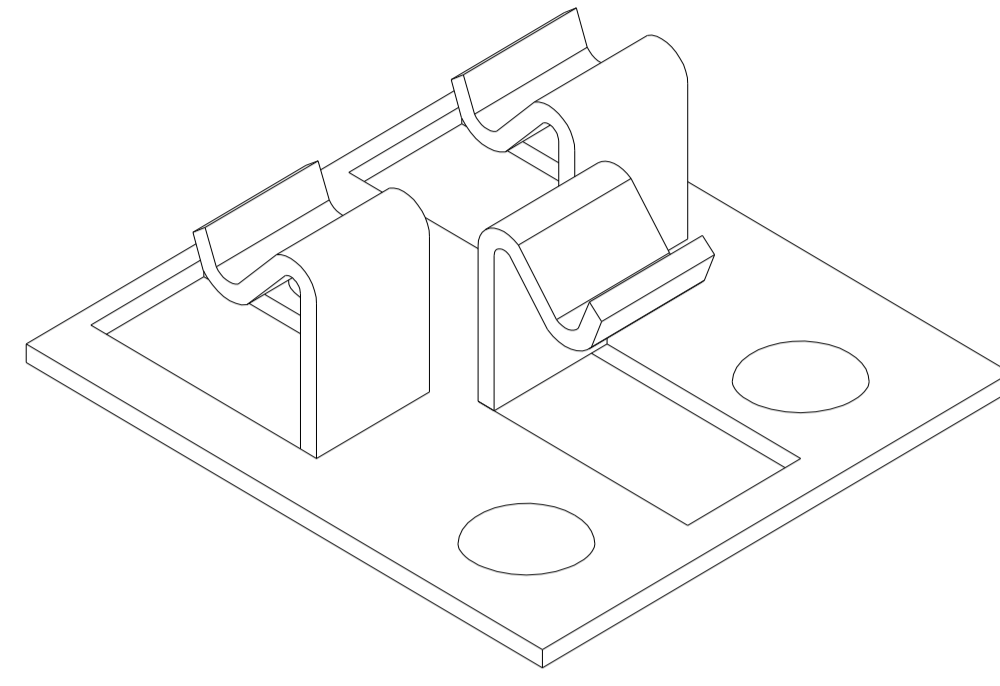

CENTER CLIP  
CODE:EWD32X29CC

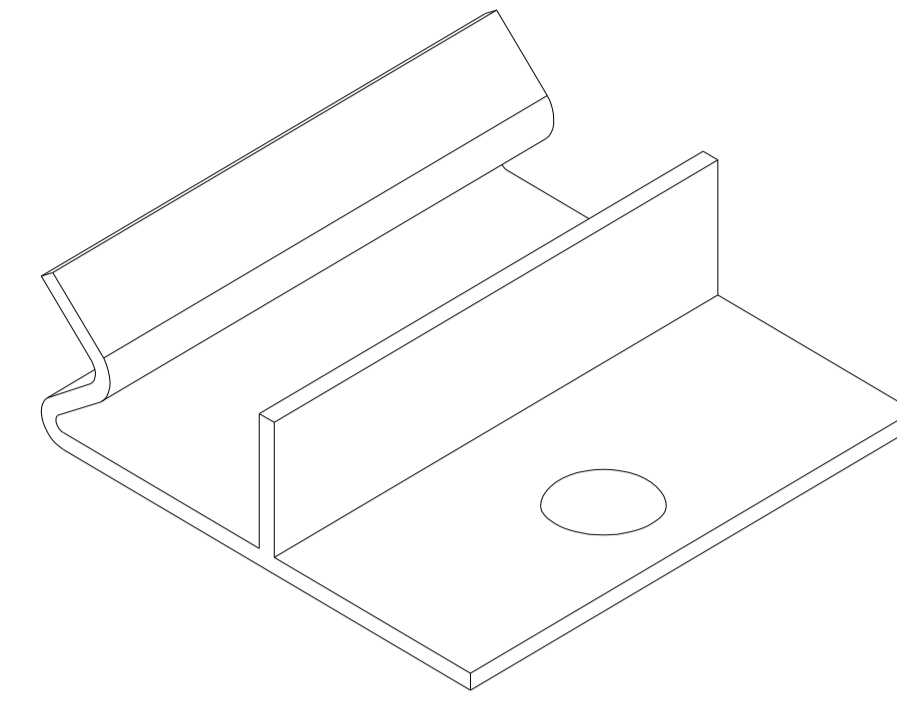

END CLIP  
CODE:EWD29X30EC

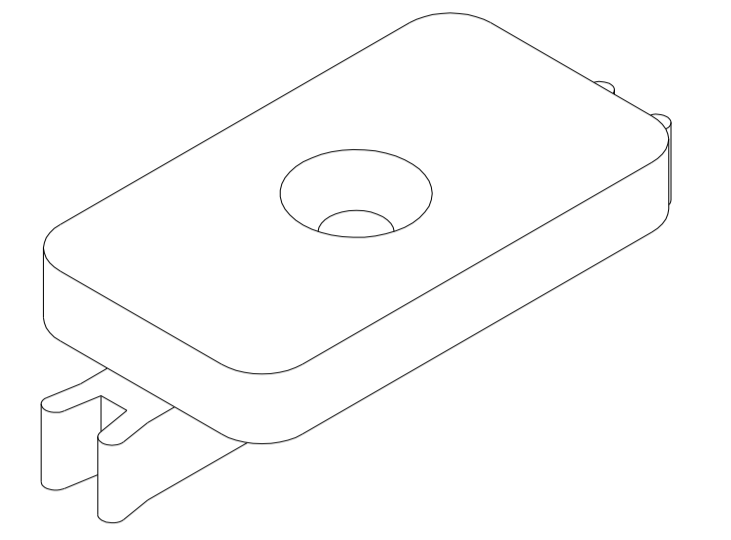

PLASTIC CLIP  
CODE:EWD18X32

## DECKING ACCESSORIES

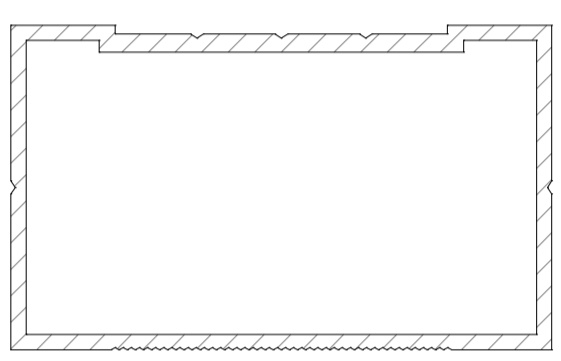

ALUMINUM JOIST  
EWD50X30ED



ALUMINUM 'L' CLAMP  
38X25X2MM THK

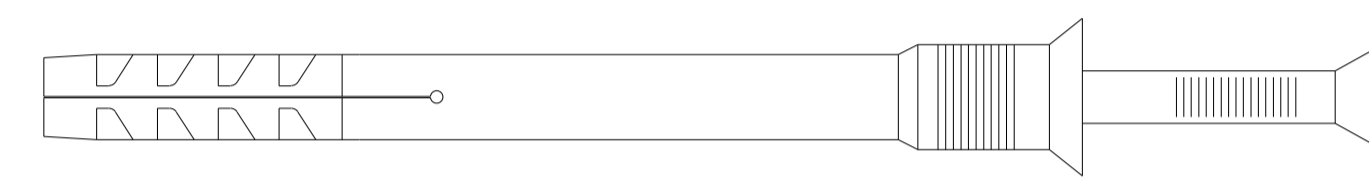

FISCHER - N SERIES  
N8/60,N8/80,N8/120,

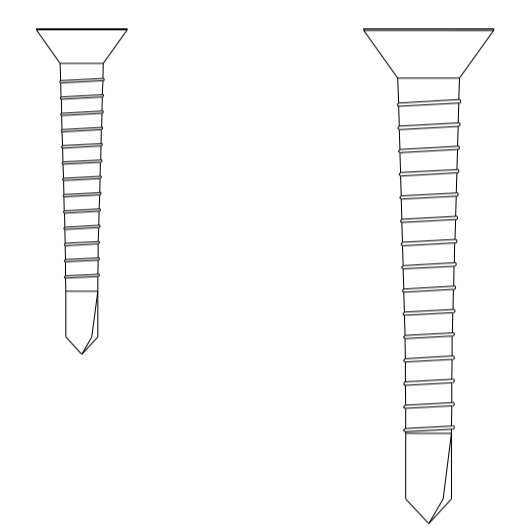

CORROSHIELD  
SELF DRILLING  
SCREWS  
7X25 / 10X38 CSK

## TOOLS AND SAFETY EQUIPMENTS

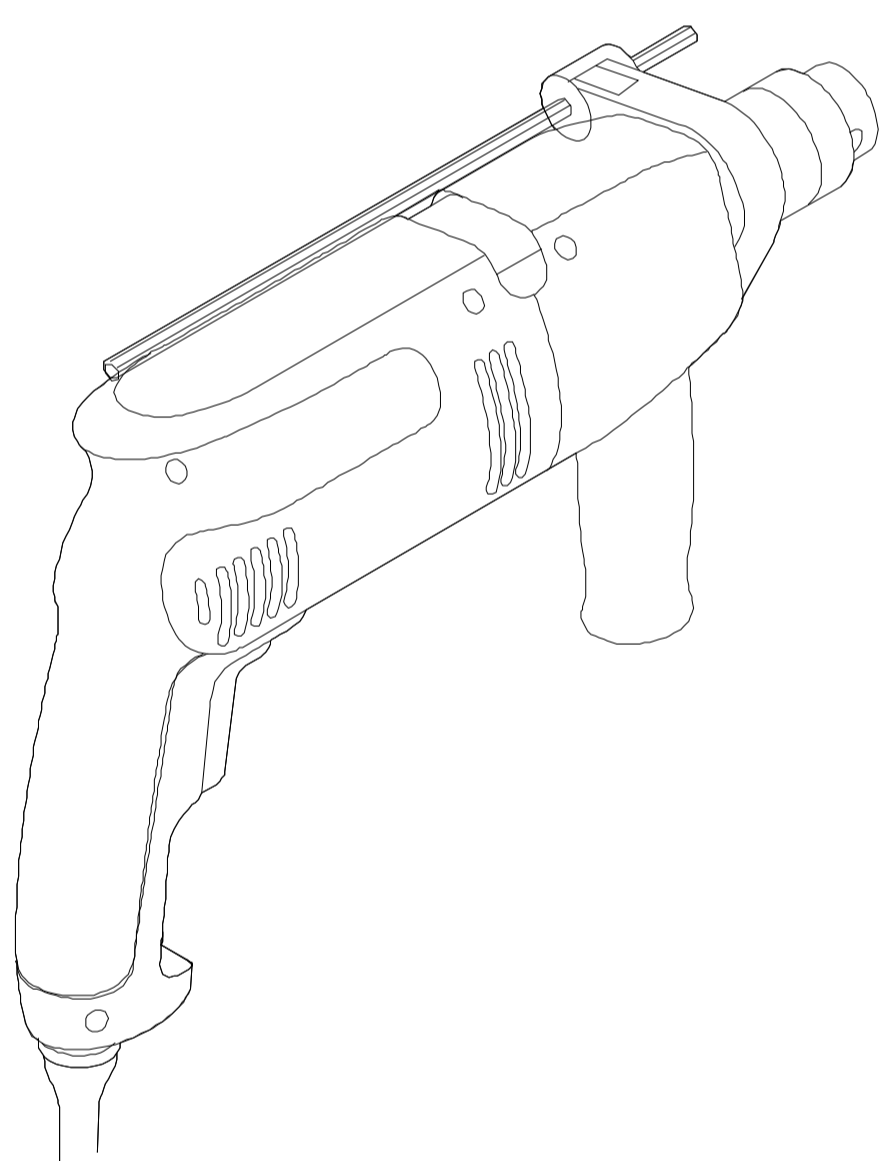

HEAVY DUTY  
HAMMER DRILL

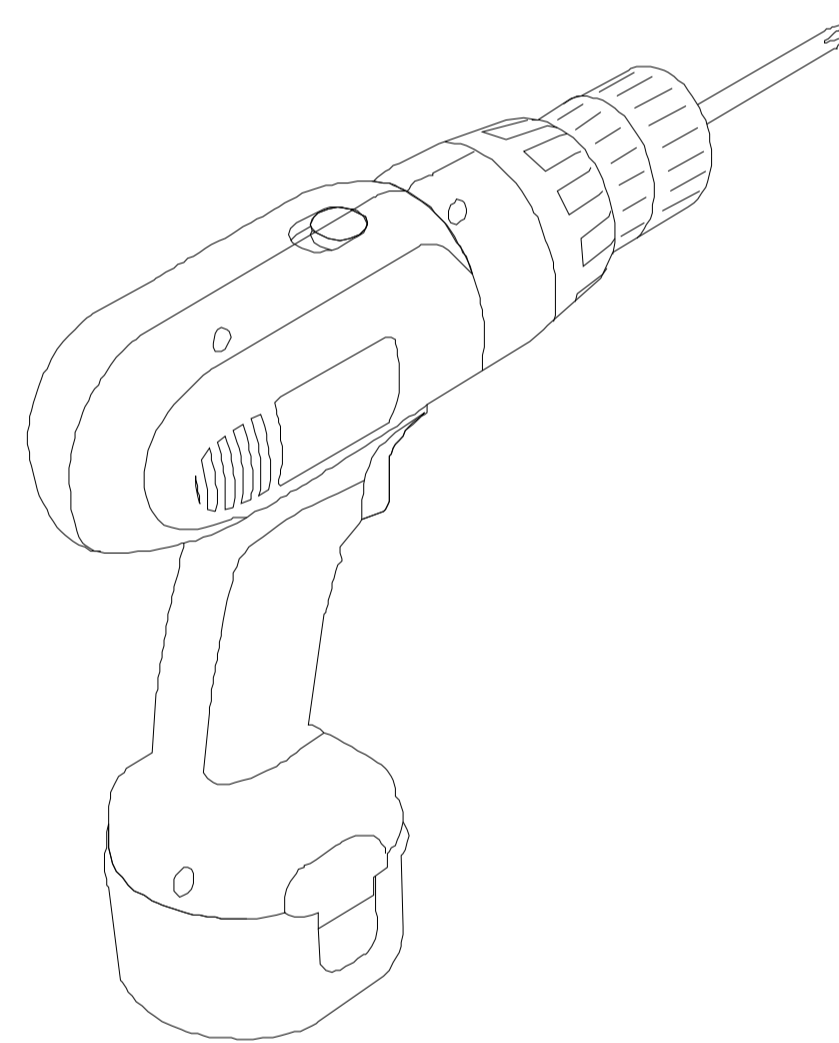

CORDLESS DRILL

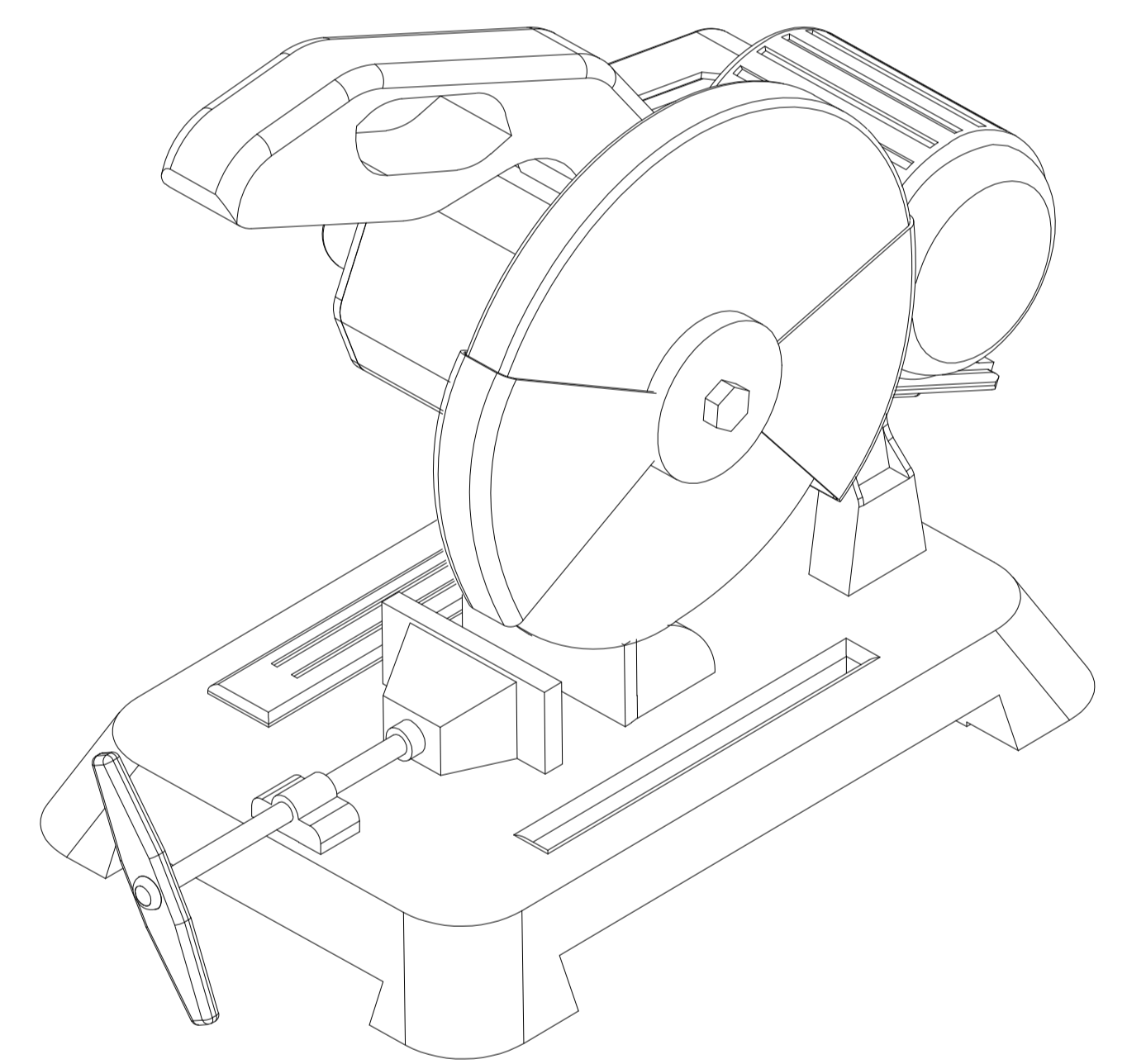

CIRCULAR  
SAW

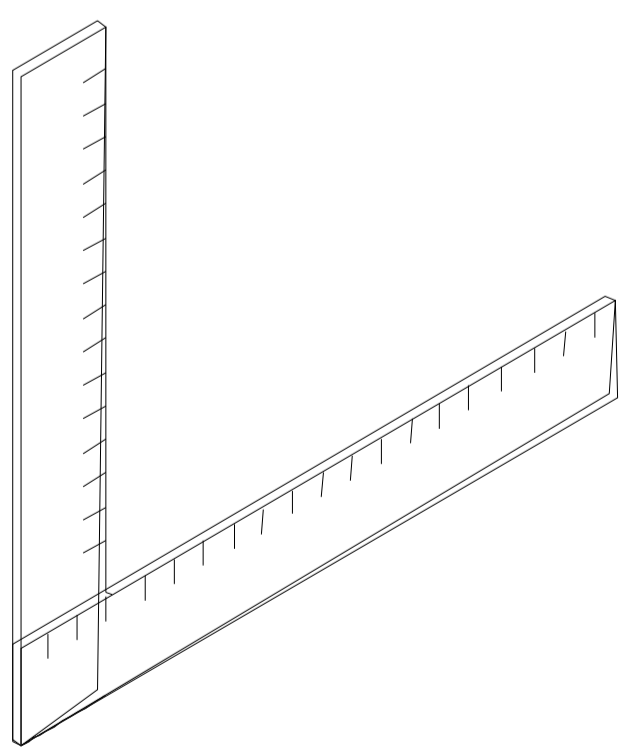

L-SQUARE

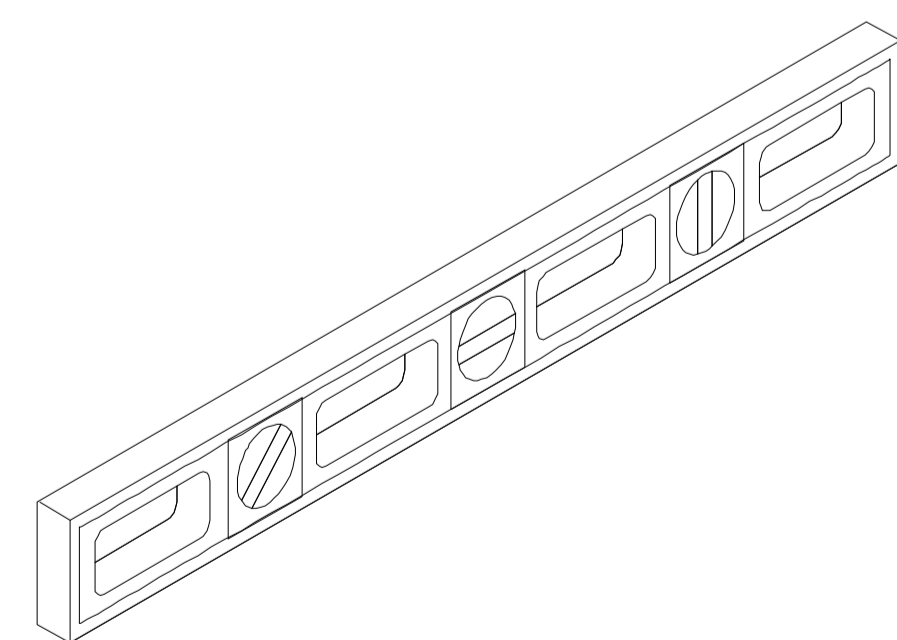

SPIRIT LEVEL

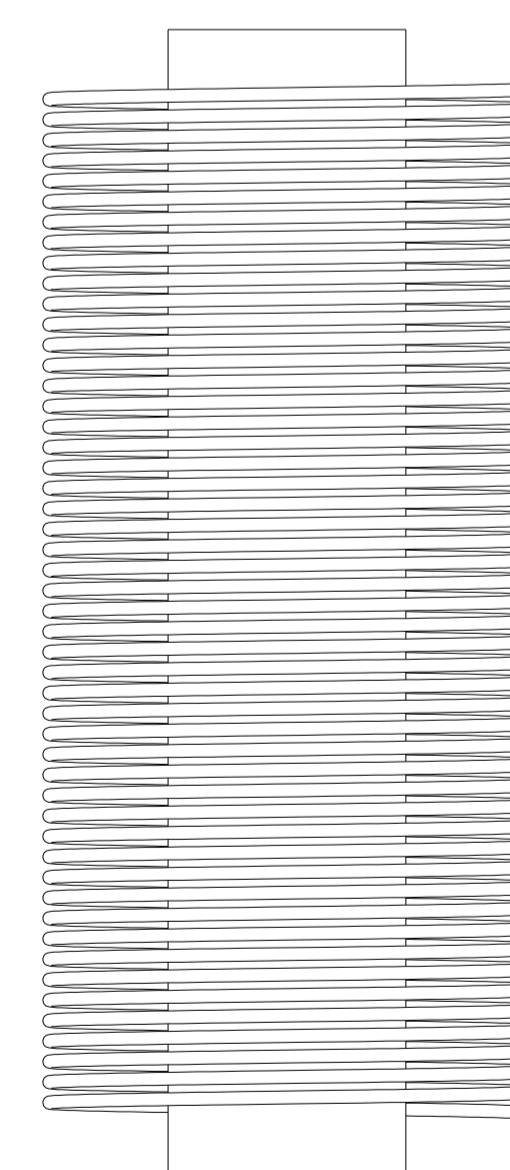

LINE THREAD

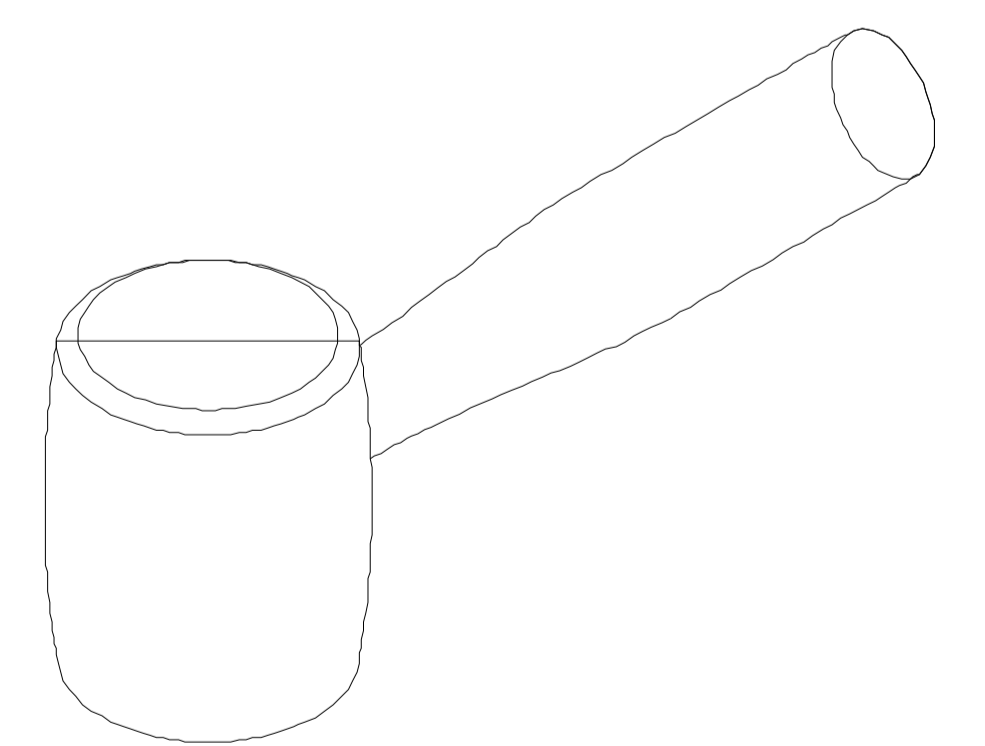

RUBBER  
HAMMER

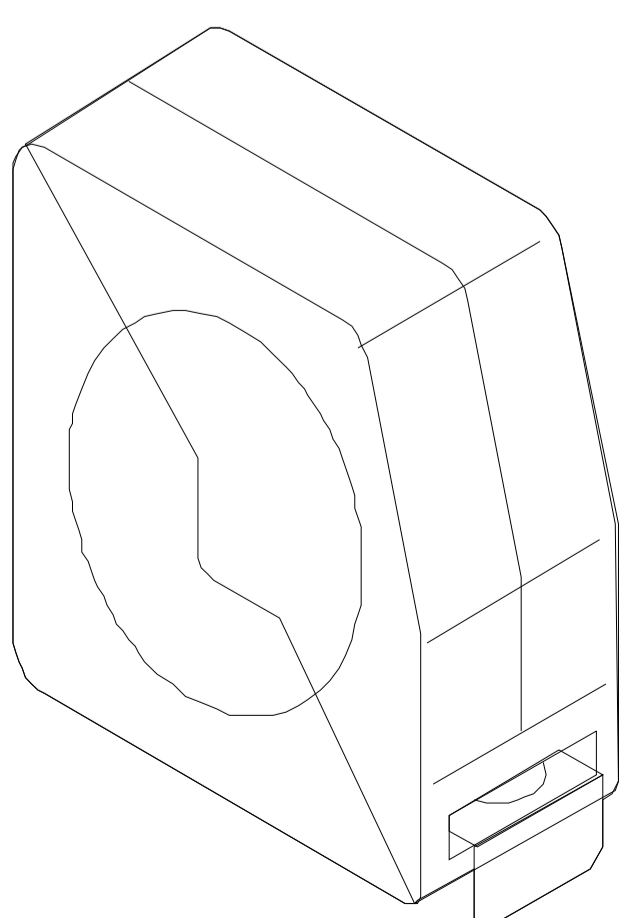

TAPE MEASURE

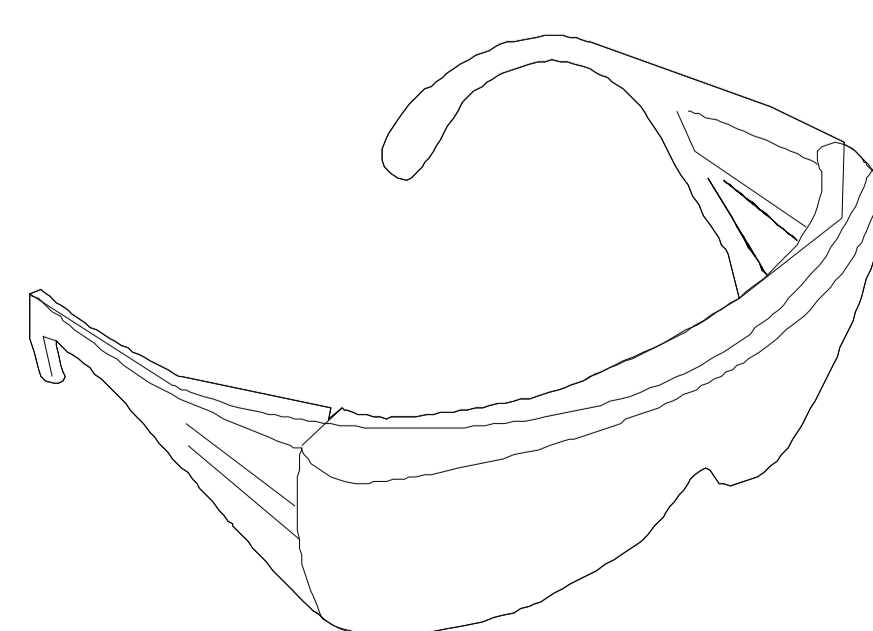

SAFETY GOGGLES

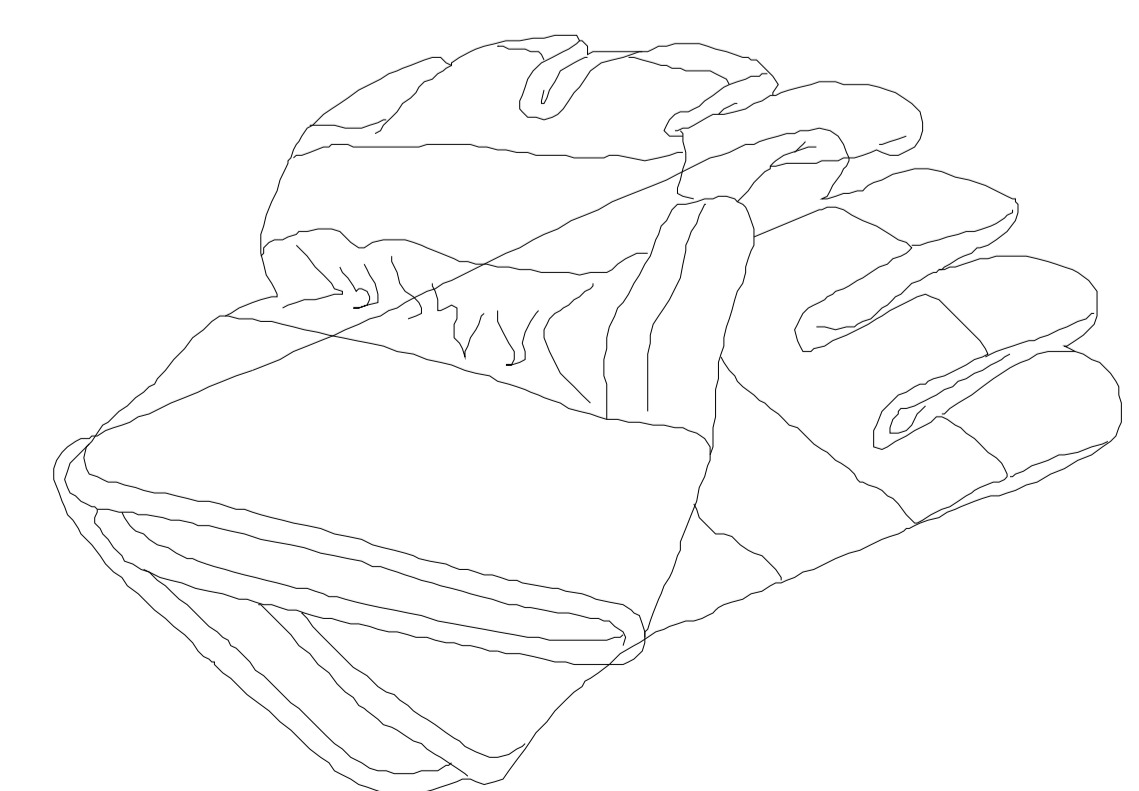

SAFETY GLOVES

# GENERAL INSTALLATION INSTRUCTIONS

Key points to be followed before and during the installation process:

1. Store the Everwood WPC material in a clean area on a flat surface with support for the entire plank. Do not provide intermediate support that can lead to the profiles bending. Planks should not be stored in direct sunlight and not in the proximity of fuels other flammable materials or electrical main boxes.
2. Before Installation, please carefully check the material notifying any damage, manufacturing defects, extreme colour variations, etc. Complaints will not be accepted once profiles are cut, sized or after installation.
3. Please always check you project / shop drawings in respect to site conditions, to verify that the received material is adequate to complete the project undertaken.
4. It is recommended to acclimatize the material to the site temperature for at least 48 hours before installation. Recommended site temperature at the time of installation should be above 20°C degrees.
5. Everwood WPC profiles should be handled with care to prevent any damage before or during the installation. Profiles should be lifted along their whole length and not slid on each other, which may cause scratches. Use clean hands free from dirt, oil or grease while handling Everwood WPC profiles.
6. Everwood WPC profiles contain a majority of wood content and therefore are susceptible to expansion both in linear & lateral directions. Dimensional shrinkage and expansion is an inherent characteristic of wood composites, and it is therefore highly recommended that the profiles are not installed other than as specified. The linear thermal expansion of Everwood WPC profiles is 1.00 mm dimensional change per meter for every 10° C degrees increase or decrease in temperature. Please ensure to leave adequate expansion gaps for thermal dimensional changes.
7. Please ensure other mechanical, civil, landscape work carried out near your Everwood WPC installation does not accumulate any dirt, dust or other debris on or between the profiles. Do not use adhesives, stickers or other material that will stain and immediately remove paint, concrete or other residues immediately.
8. Please visit [www.everwoodwpc.com](http://www.everwoodwpc.com) for care and maintenance instruction of your Everwood WPC profiles and installations.
9. Everwood WPC warranty will be rendered null and void as a result of improper handling incorrect installation or wrong use of the product. Please ask for our warranty terms if required to better understand the limitations of the warranty.
10. WARNING: It is to be noted that failure to strictly comply with all criteria of recommended expansion gaps, spans, fixed / floating points for application of Everwood profiles can cause misalignment of joints and even deformation of the profiles itself.

## IMPORTANT NOTES

To ensure that you get the best out of using Everwood wpc products, it is highly recommended to use only the highest quality / grade of fittings & fixtures while installing our products. Everwood only specifies industry leading brands of other components as specified below:

1. Aluminium : Virgin extruded T5 / T6 hardness
2. Fixtures : Everwood specified SS304 / pa grade clips and fixtures or anti-corrosive aluminum fixtures
3. Fasteners : Bosch / fischer / equivalent brands of anti-corrosive expansion anchors & fasteners.
4. Screws : Corrosheild or equivalent countersunk, waferhead anti-corrosive screws please note that warranty of installations does not hold valid if deviations are made from installation material specifications as outlined by Eeverwood wpc
5. Mild steel : All ms tube or other sections used for Everwood wpc profiles including for pergolas & fins re-inforcement inserts and fixtures are to be of isi grade steel, mandatorily treated with 2 coats of pu anti-corrosive primer and 2 coats of pu paint (only for exposed use).

# SITE PREPARATION DETAIL

1

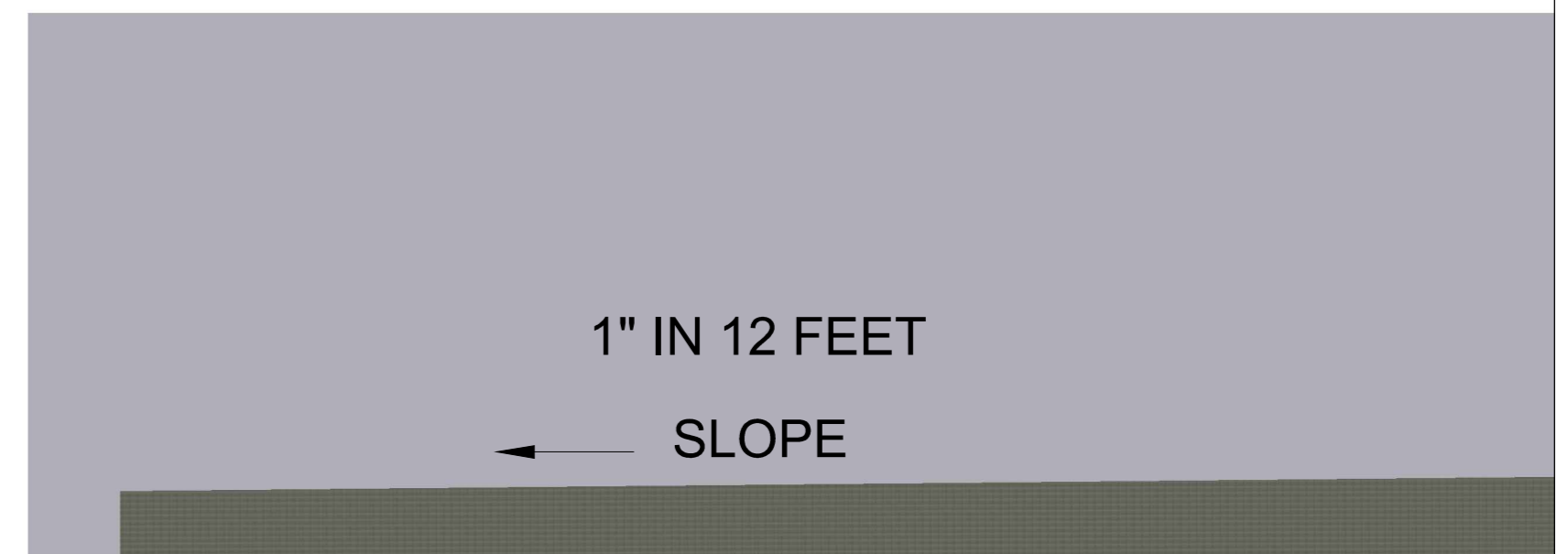
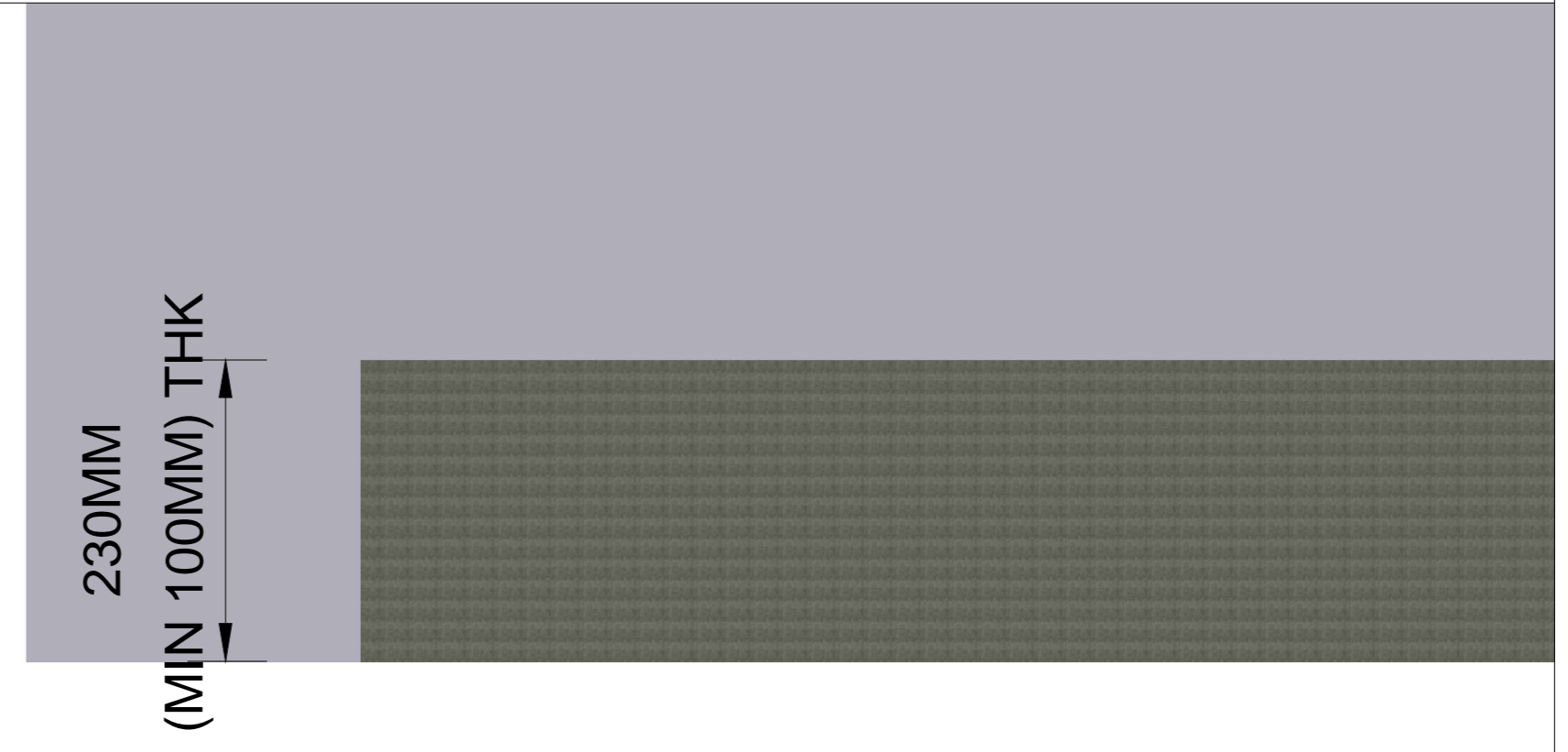
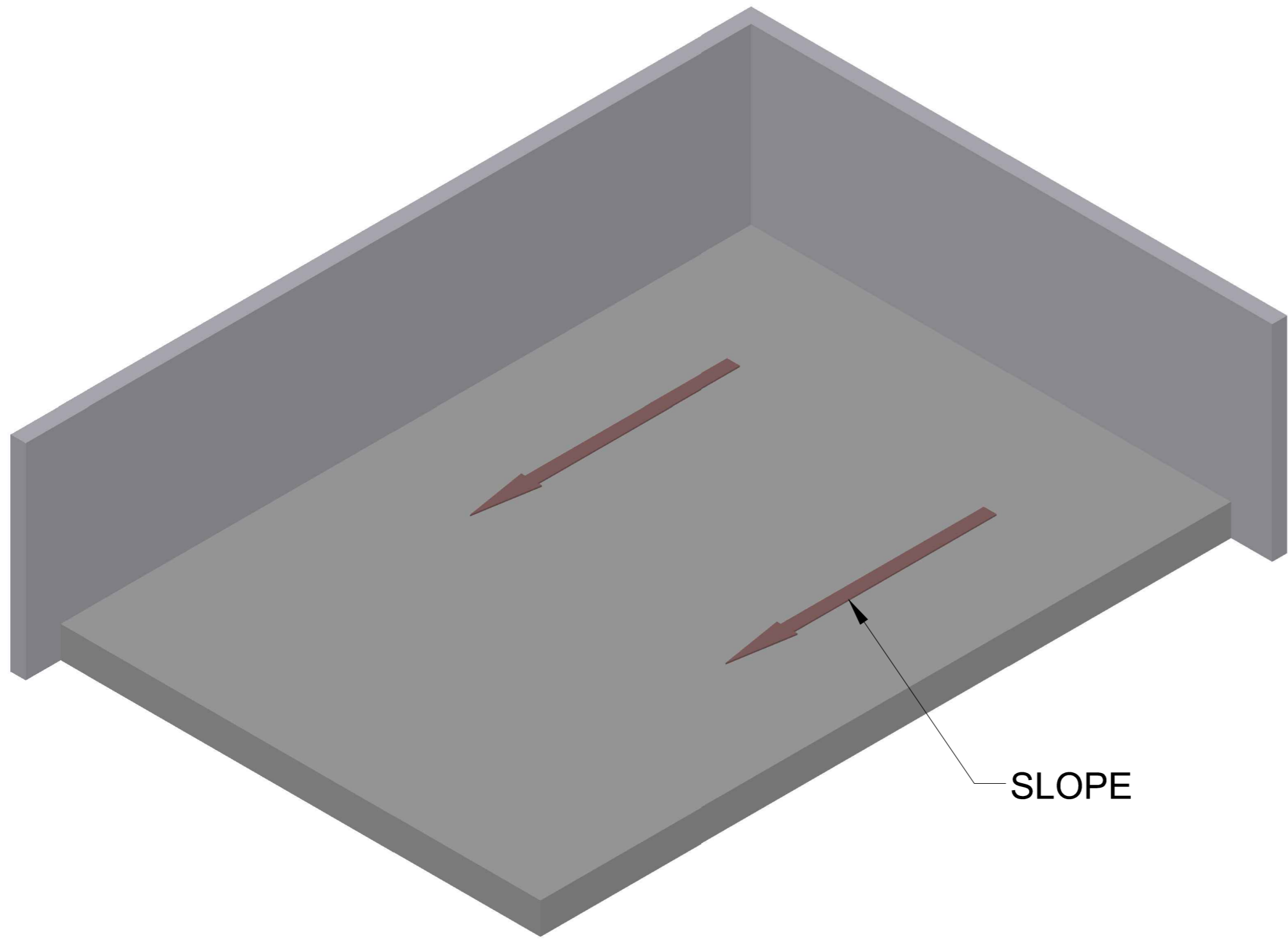

MAKE SURE THAT THE SURFACE AREA TO BE DECKED IS FLAT AND STABLE FROM LOOSE MORTAR OR DEBRIS. THE CONCRETE SUB-FLOOR SHOULD BE AT LEAST 100MM THICK AND SMOOTH PLASTERED WITH A SLIGHT SLOPE OF 25MM EVERY 12 FEET FOR WATER COLLECTING BELOW THE DECK PLANKS TO RUN OFF. IN THE CASE OF A STEEL FRAME STRUCTURE TO SUPPORT THE DECK, THE SPACING OF ADEQUATE STRENGTH MS TUBES TO BE AT INTERVALS NOT EXCEEDING 750MM CENTER TO CENTER

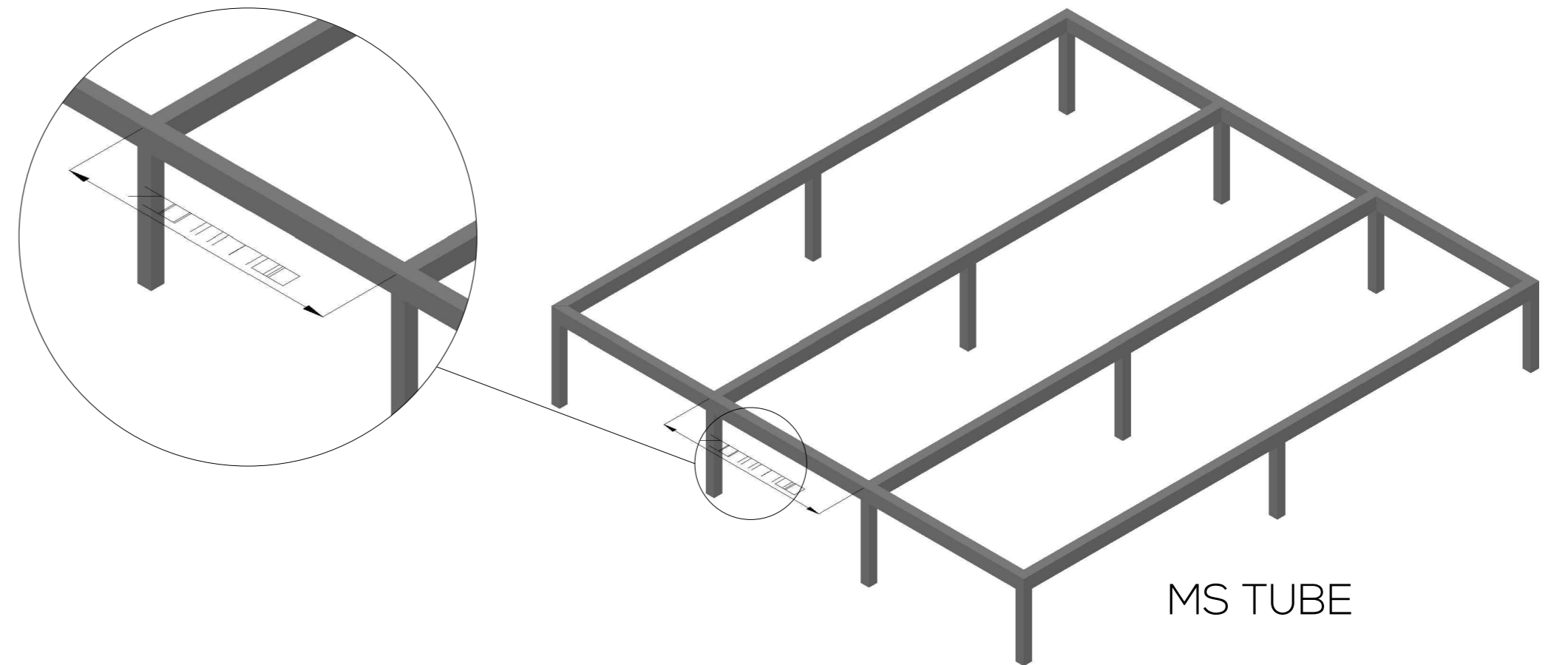

# JOIST FIXING DETAIL

2

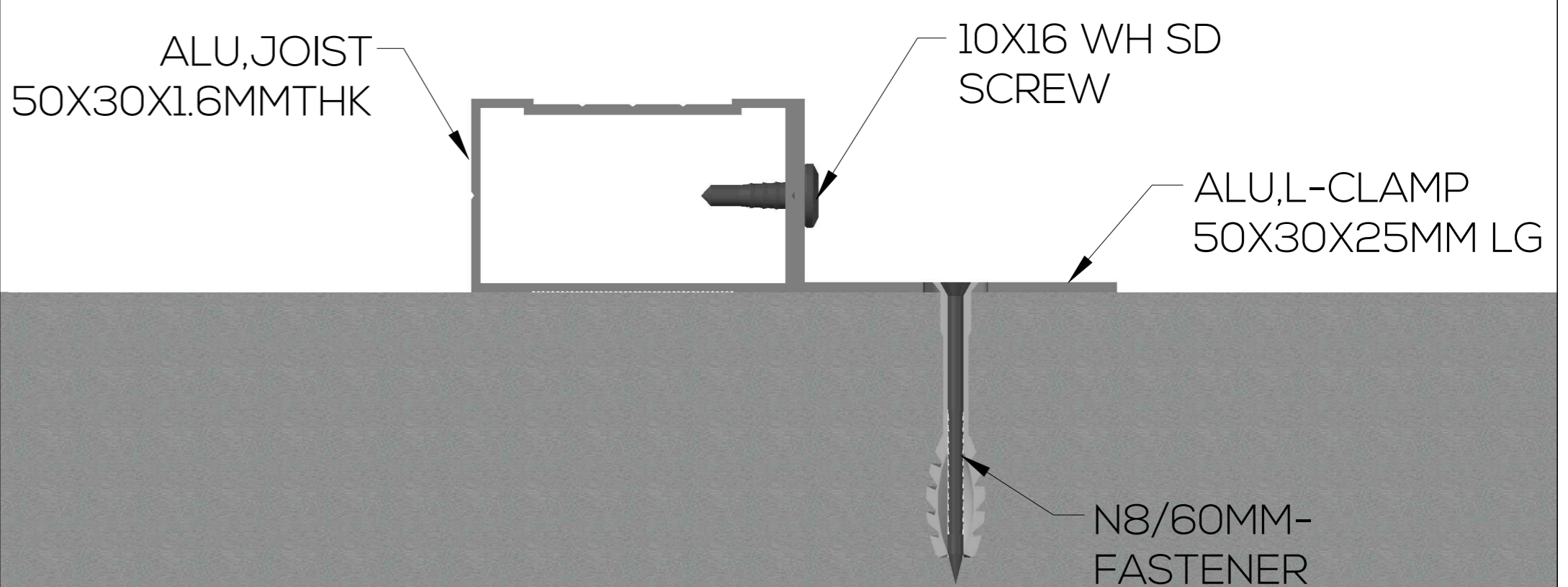
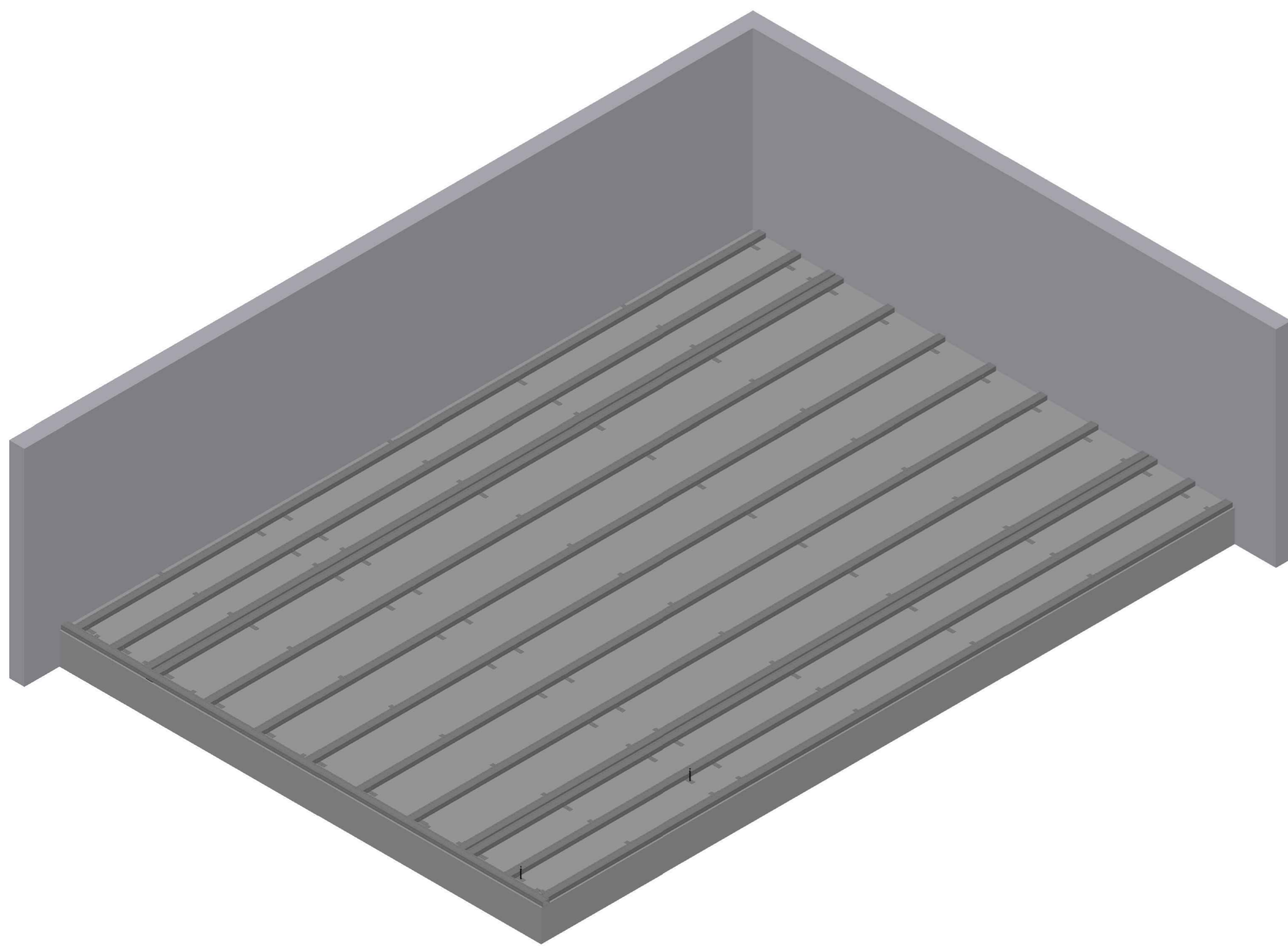

THE MAXIMUM RECOMMENDED SPACE / SPAN BETWEEN JOIST ROWS SHOULD NEVER EXCEED 350MM CENTER TO CENTER. DOUBLE JOISTS ARE TO BE INSTALLED AT THE BOARD JOINTS. REFER THE DIAGRAM HERE. USE THE REQUIRED L CLAMPS FASTENED TO THE FLOOR / STEEL FRAME WITH EXPANSION / SELF TAPPING SCREWS AT INTERVALS NOT EXCEEDING 750MM FROM EACH OTHER, USING 10X16 WH SD SCREWS TO CONNECT THE ALUMINUM JOIST TO THE 'L' CLAMP. IF THE SUBFLOOR IS VERY SLOPED SPACERS MAY BE REQUIRED TO GET A GOOD TOP LEVEL OF THE DECK

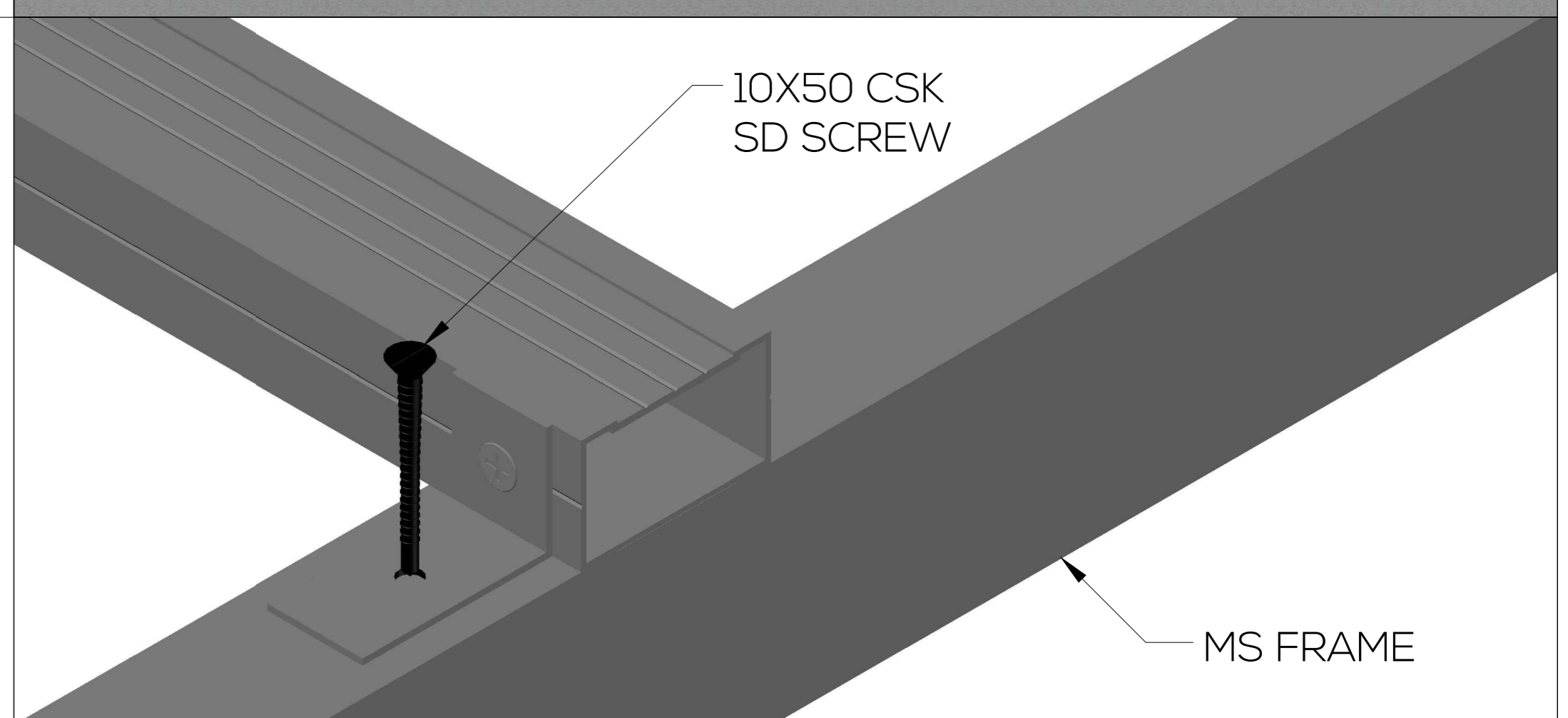

## START CLIP & FIRST BOARD FIXING DETAIL

3

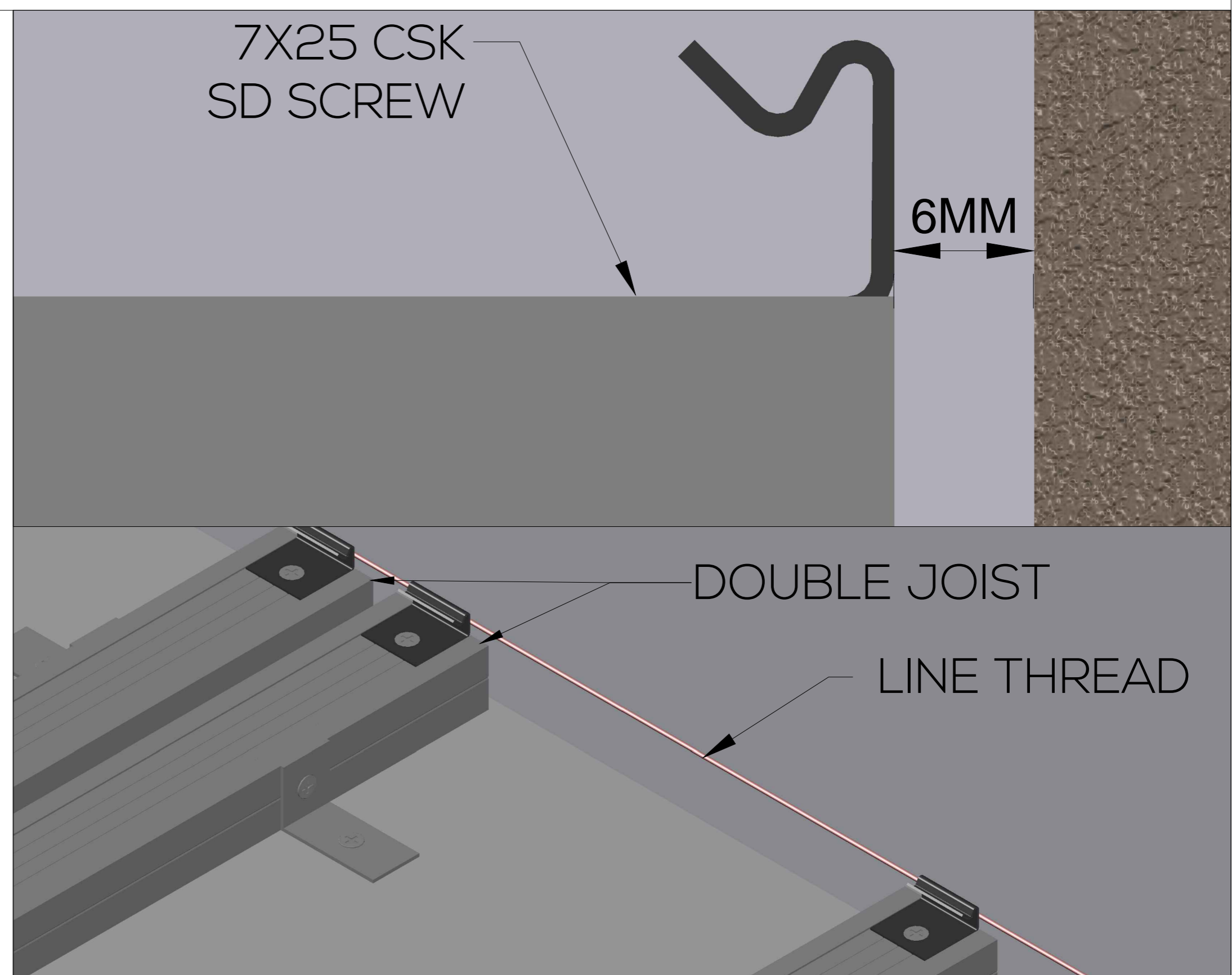
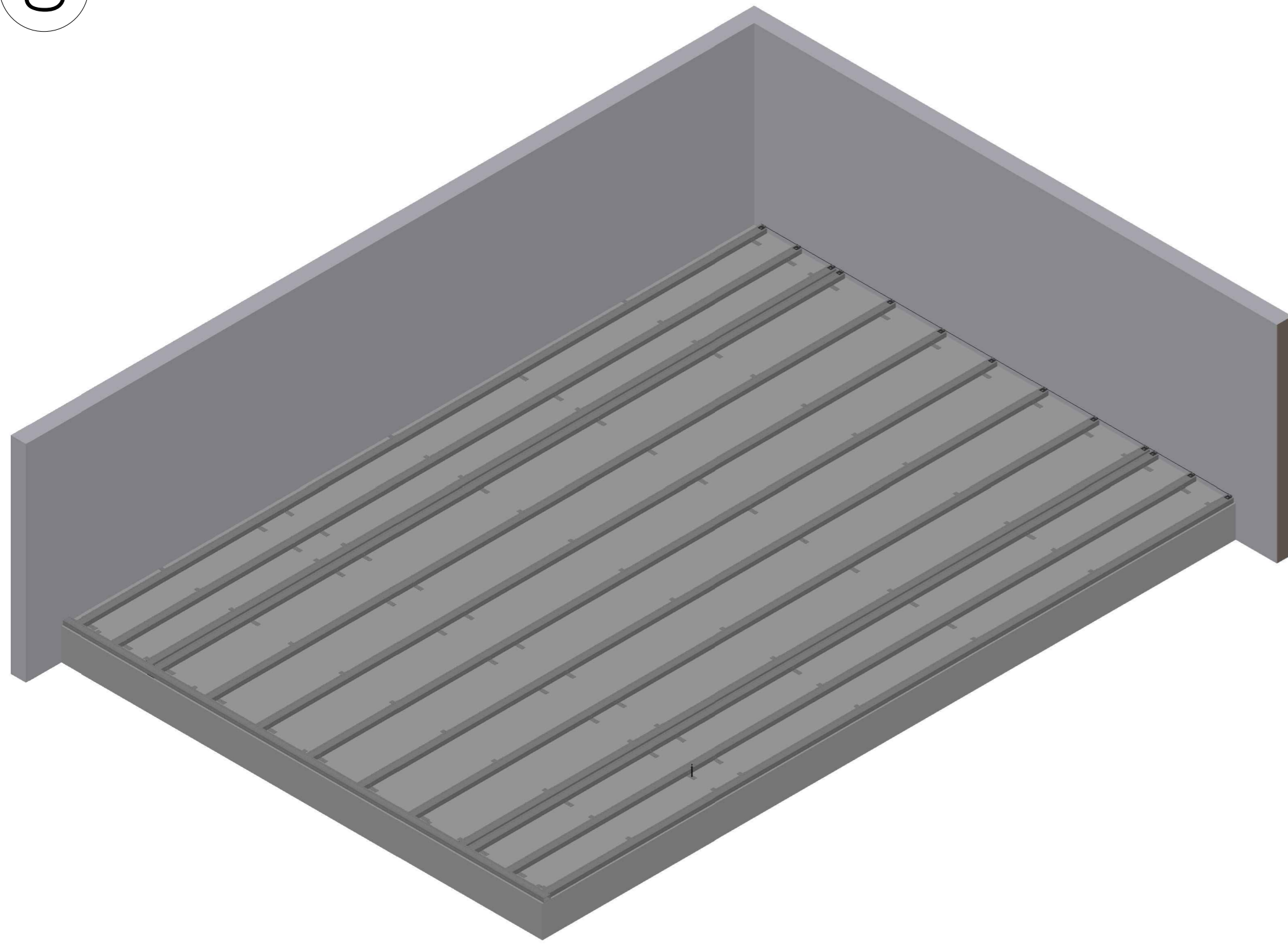

A START CLIP NEEDS TO BE FIXED TO A THREAD LINE AT THE START END OF EACH JOIST WHERE YOU INTEND TO START THE DECK. THESE START CLIPS ARE FIXED WITH A SELF TAPPING SCREW AND LEAVING 6-8 MM BETWEEN THE WALL AND END OF THE JOIST TO ALLOW FOR EXPANSION. OUR COMPOSITE BOARDS ARE THEN EASILY LOCKED INTO THE START CLIPS. LEAVE A 6-8MM GAP BETWEEN LATERAL JOINTS ALSO TO ALLOW FOR EXPANSION.

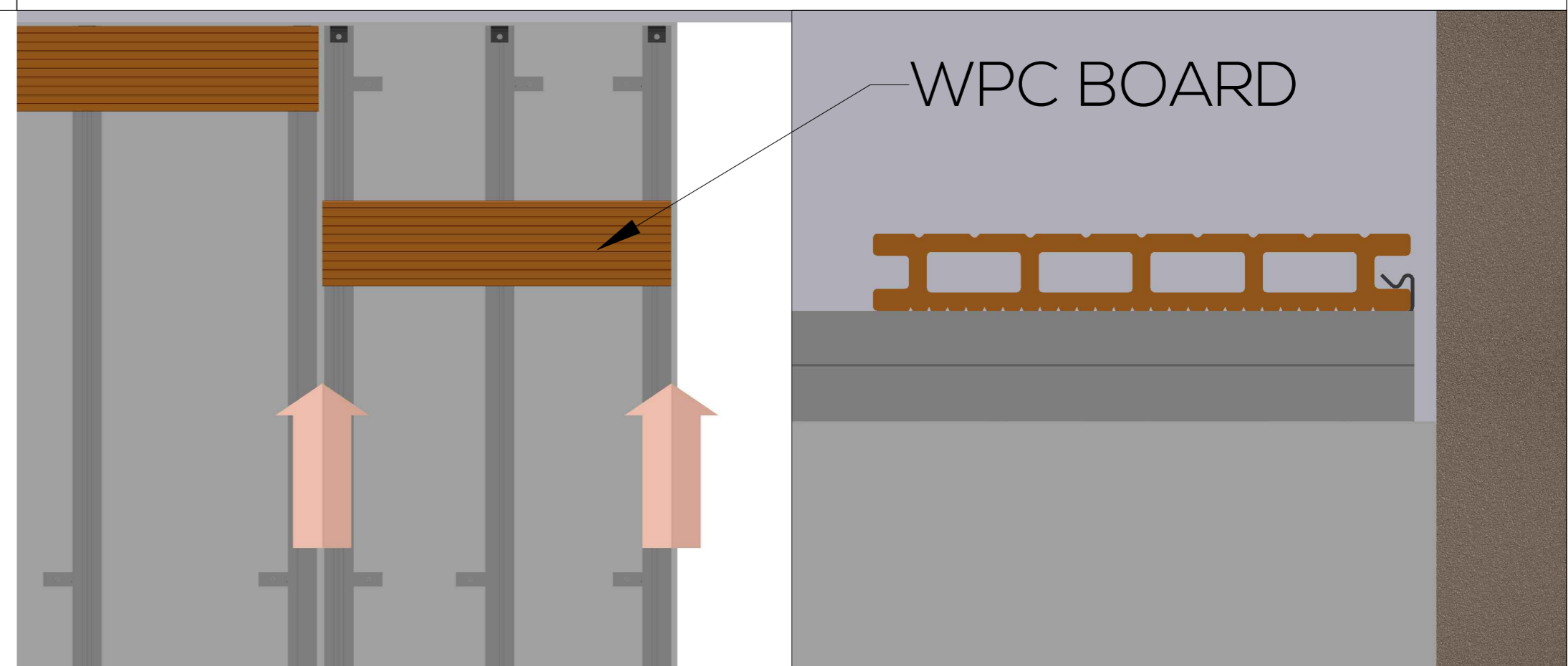

## CENTER CLIP FIXING AND LOCKING SCREW DETAIL

4

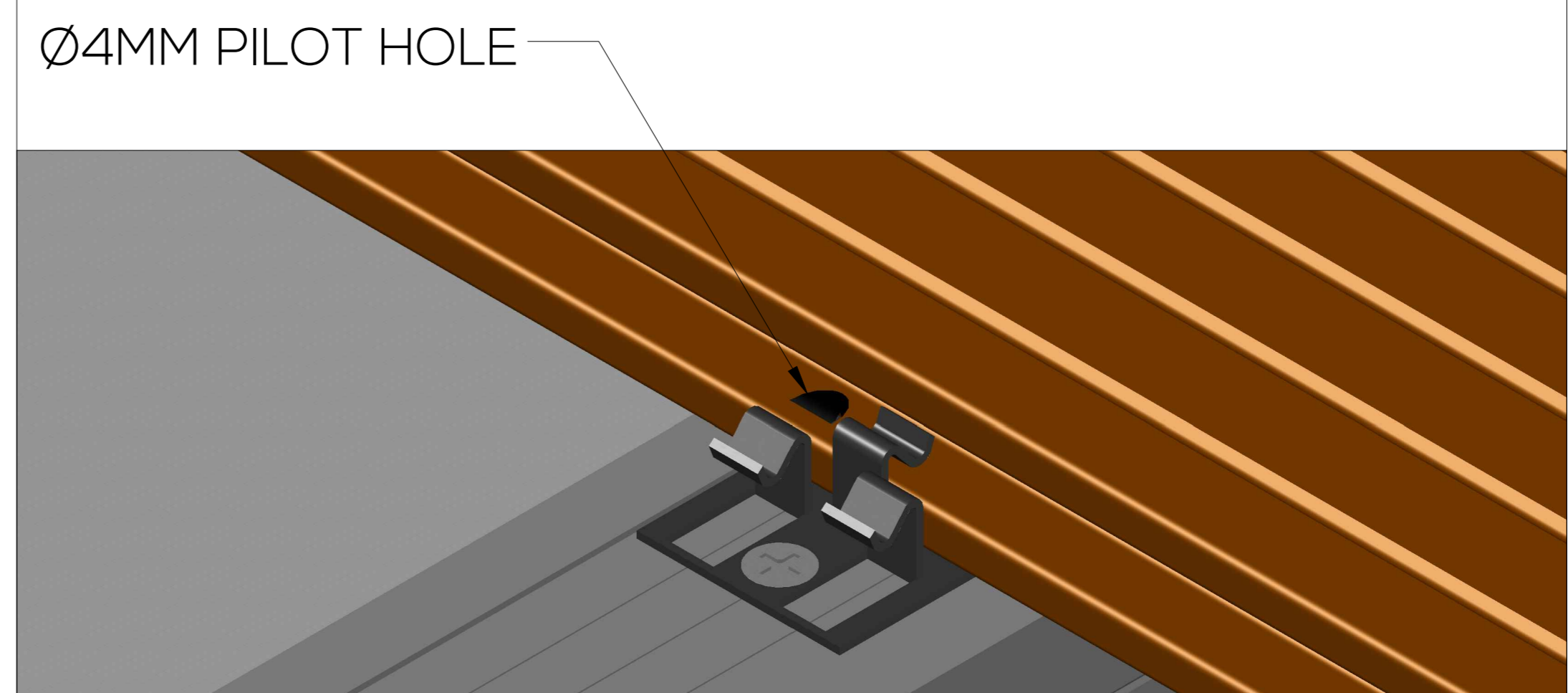
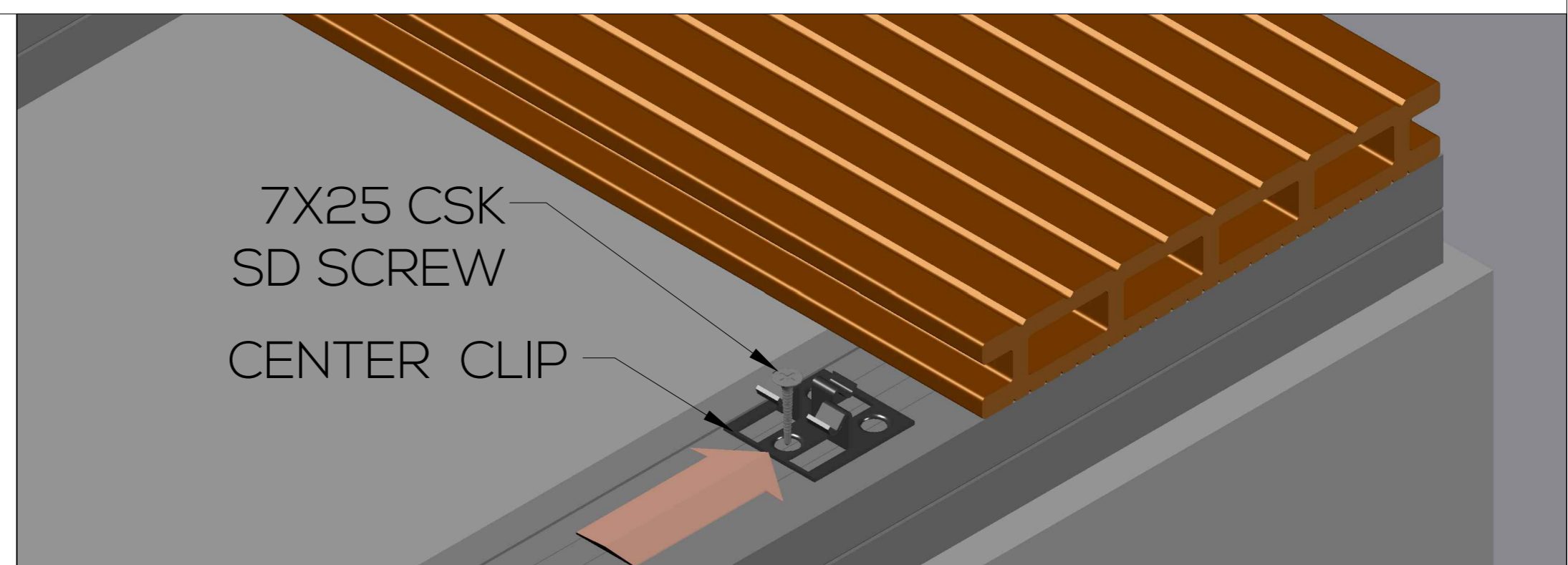
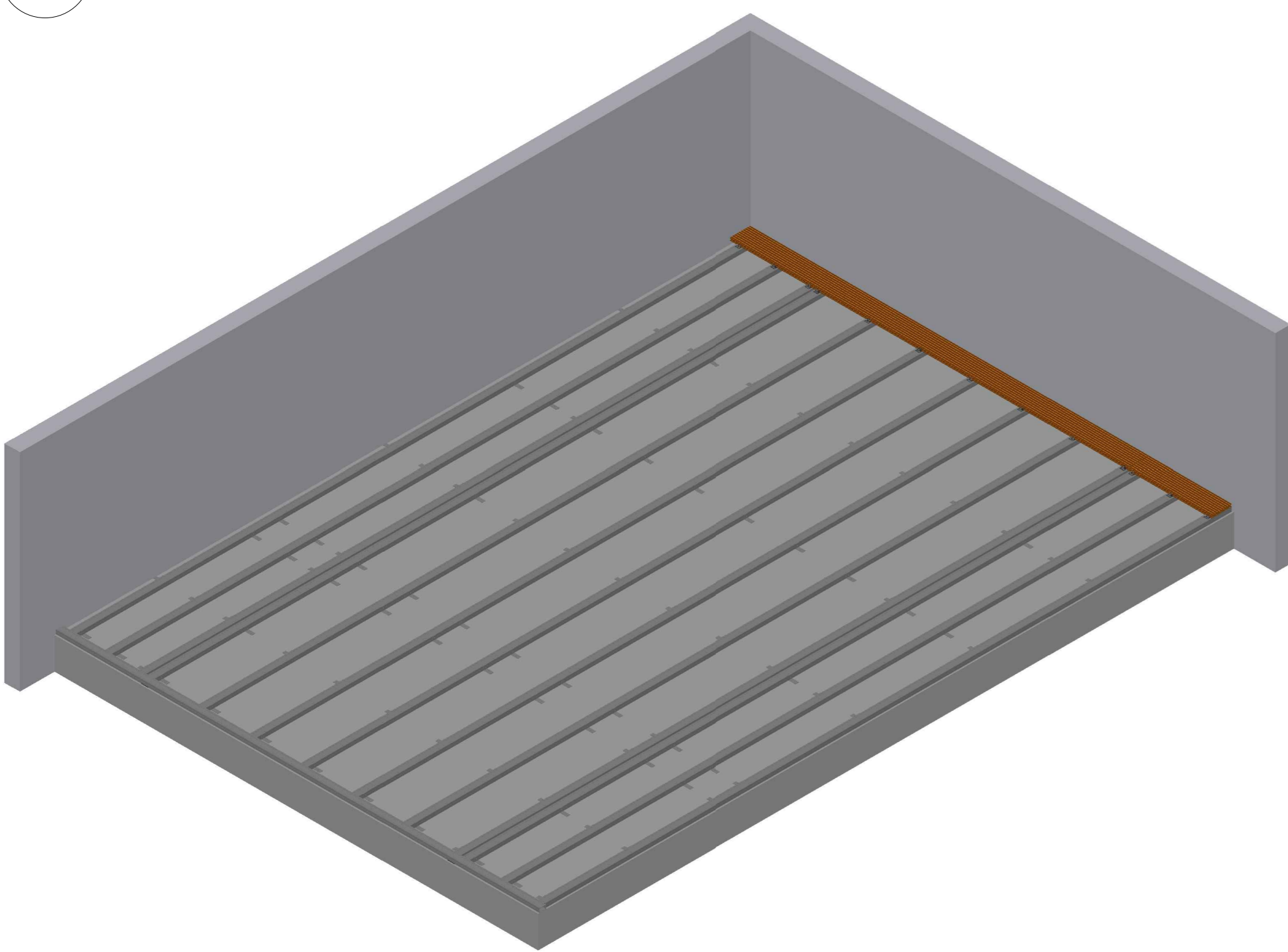

SLIDE AND PLACE THE CENTER CLIPS AT EVERY JOIST TO SECURE THE DECK PLANK. IT IS IMPORTANT TO ALTERNATE THE CLIPS WITH SINGLE & DOUBLE FINGERS TO SECURE THE BOARD PROPERLY. NOW SCREW THE CENTER CLIPS DOWN INTO THE ALUMINUM JOIST WITH SELF TAPPING SCREWS. THE GAP BETWEEN BOARDS IS DEFINED BY THE CENTER CLIP. TO AVOID LINEAR MOVEMENT OF THE BOARDS WITH EXPANSION, USE 3 NOS OF SELF DRILLING SCREWS THROUGH A 4MM LARGER DIAMETER PILOT HOLE FOR EACH BOARD OF 2.90M LENGTH

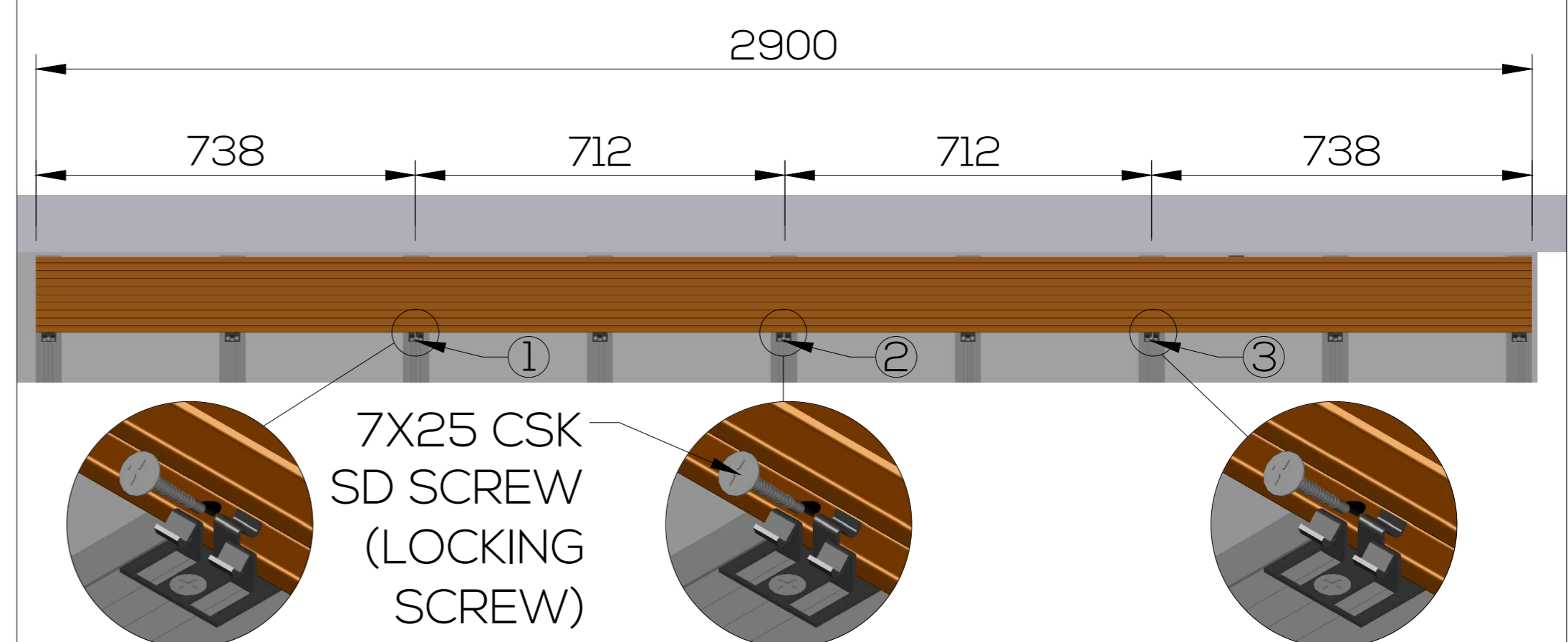

## SECOND & OTHER BOARD FIXING DETAIL

5

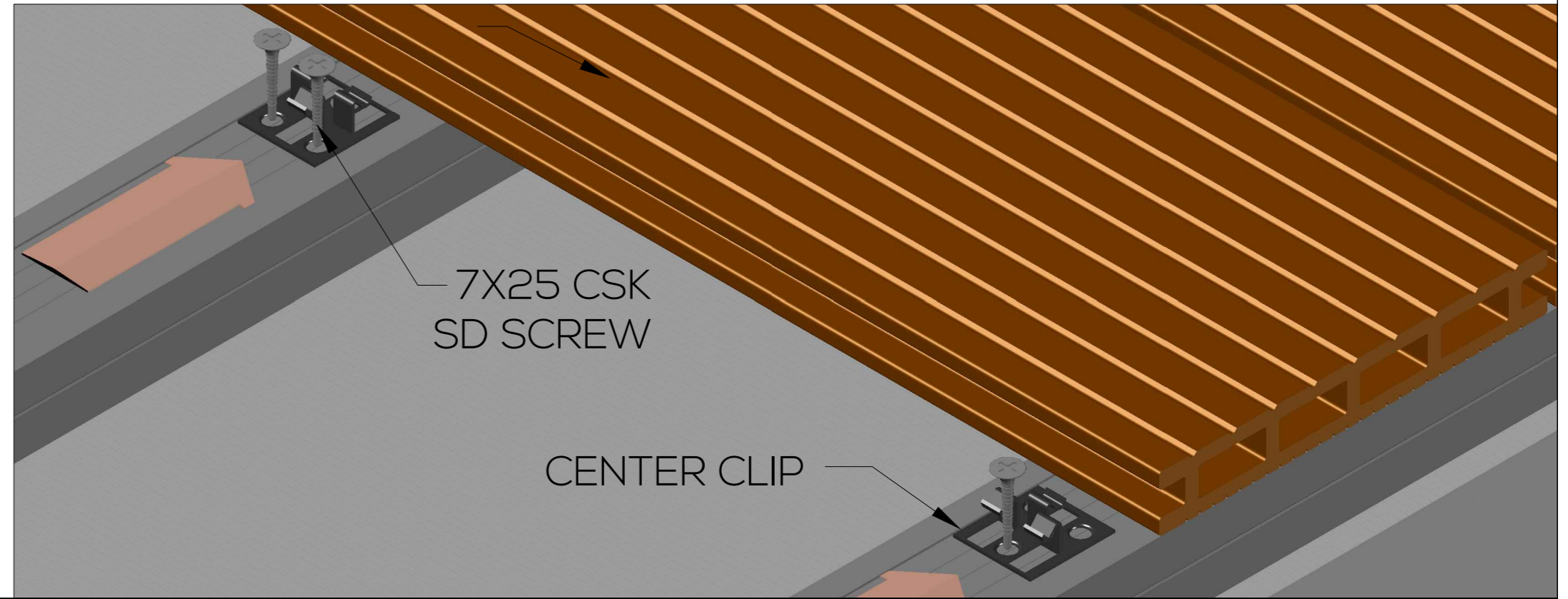
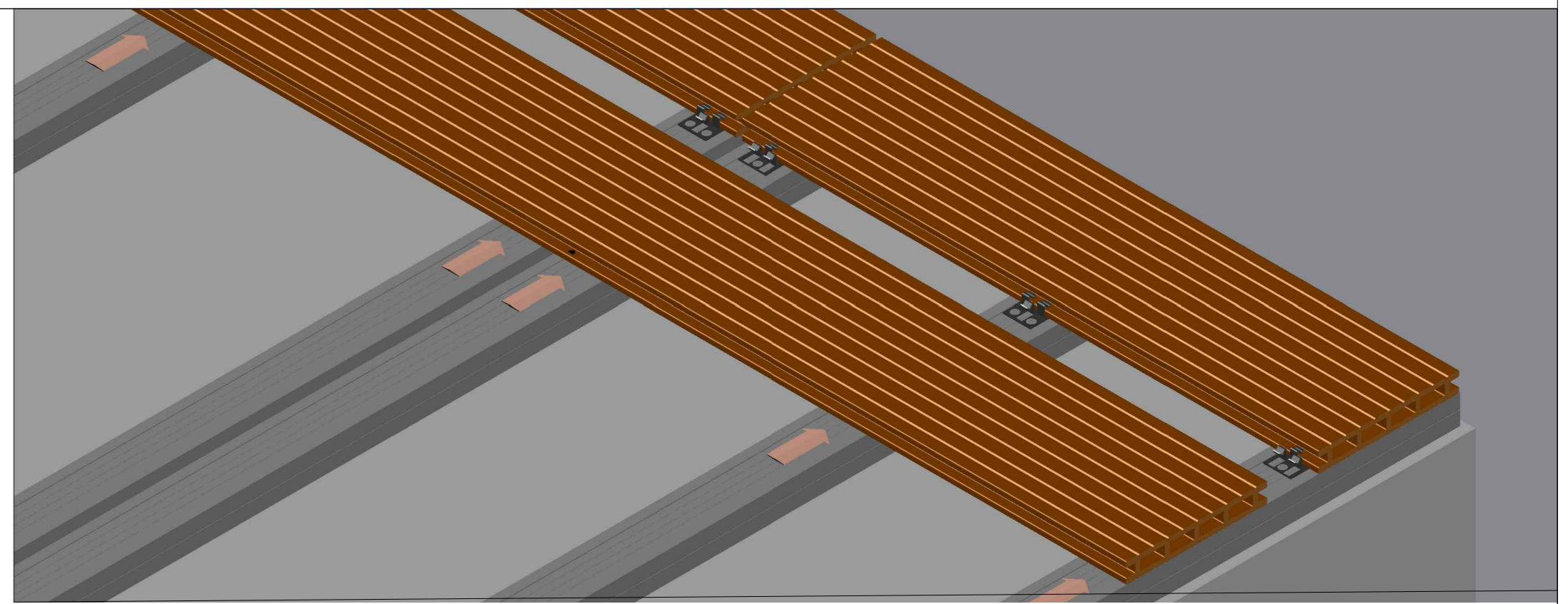
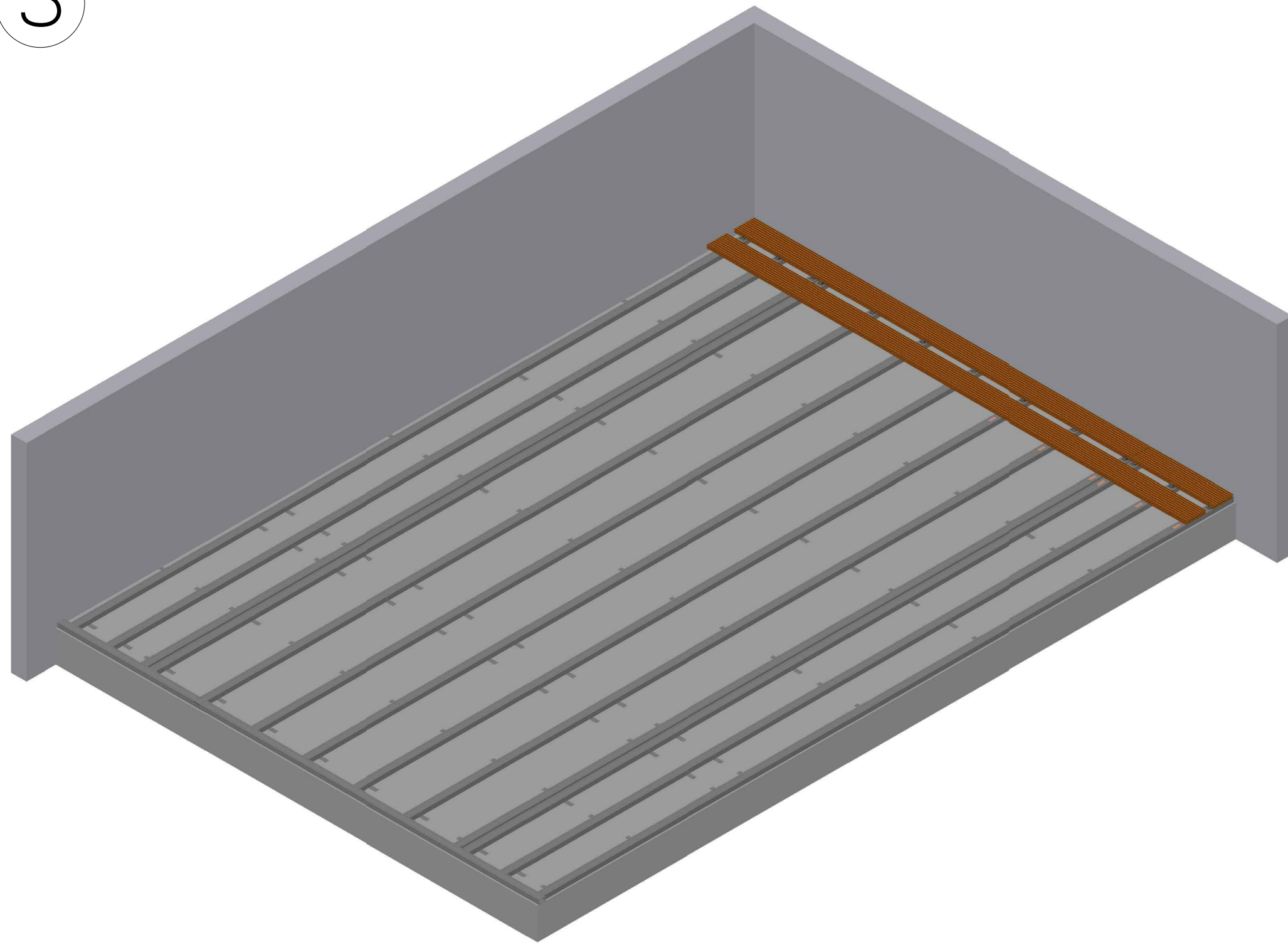

AFTER THE CENTER CLIP TO FASTEN THE FIRST BOARD IS SCREWED DOWN, SIMPLY PLACE THE NEXT BOARD INTO THE CLIPS LEAVING THE GAP BETWEEN BOARDS AS DEFINED BY THE CENTER CLIP. DO NOT TRY TO TIGHTEN THE BOARDS ANY FURTHER, WHICH WILL REDUCE THE GAPS BETWEEN BOARDS. AS DONE WITH THE FIRST BOARD, PLACE THE NEXT ROW OF CENTER CLIPS AT EACH JOIST AND SCREW DOWN TO SECURE THE PLANKS. CHECK AND MAINTAIN THE EVEN GROOVE WIDTH EVERY 4-5 ROWS OF DECK BOARDS.

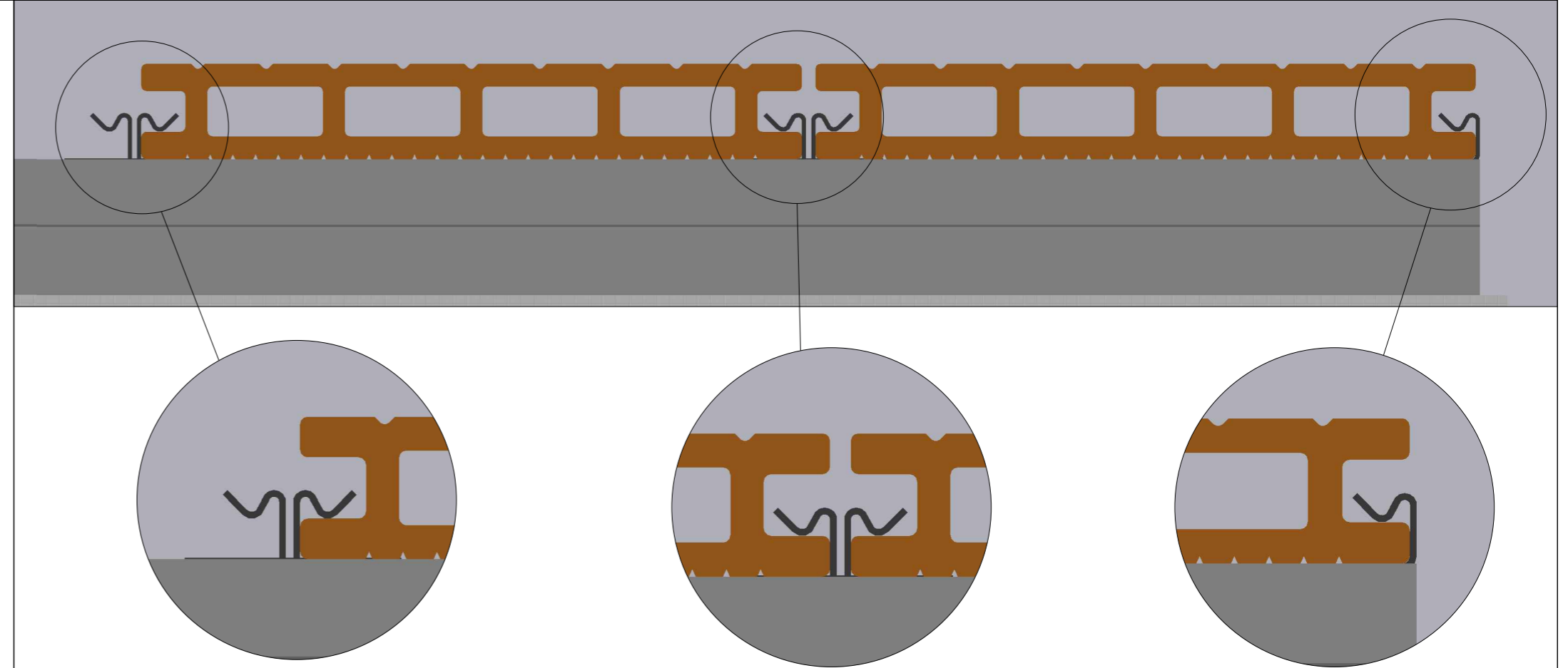

## EXPANSION GAP & END CLIP FIXING DETAIL

6

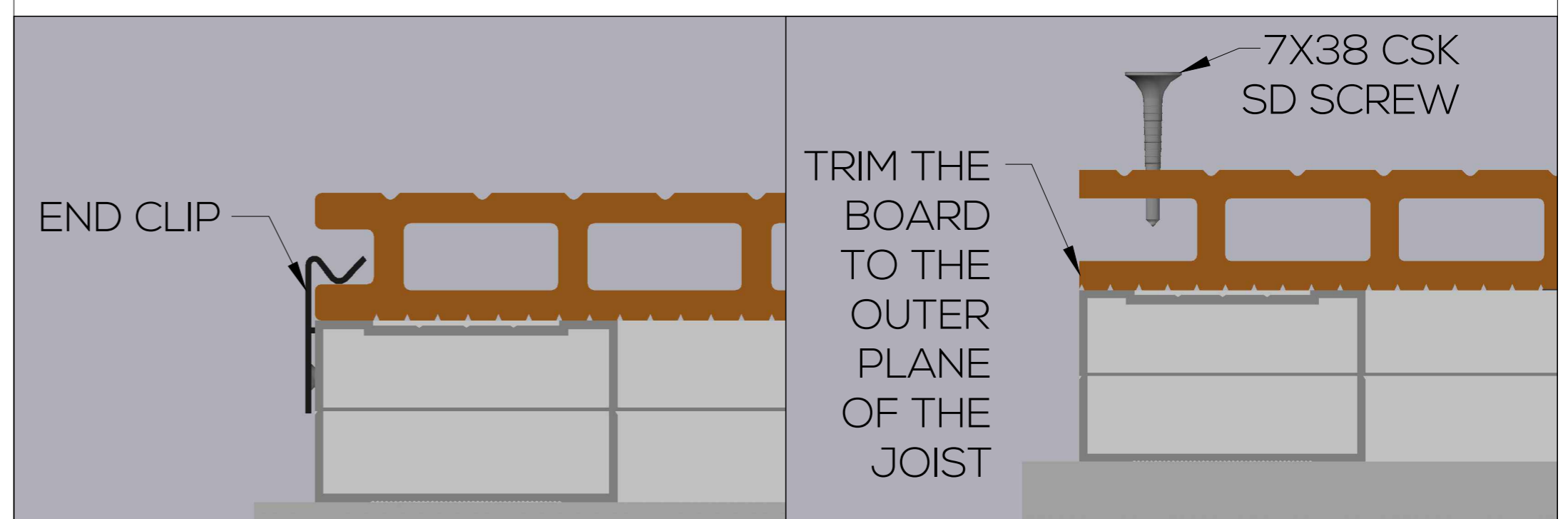
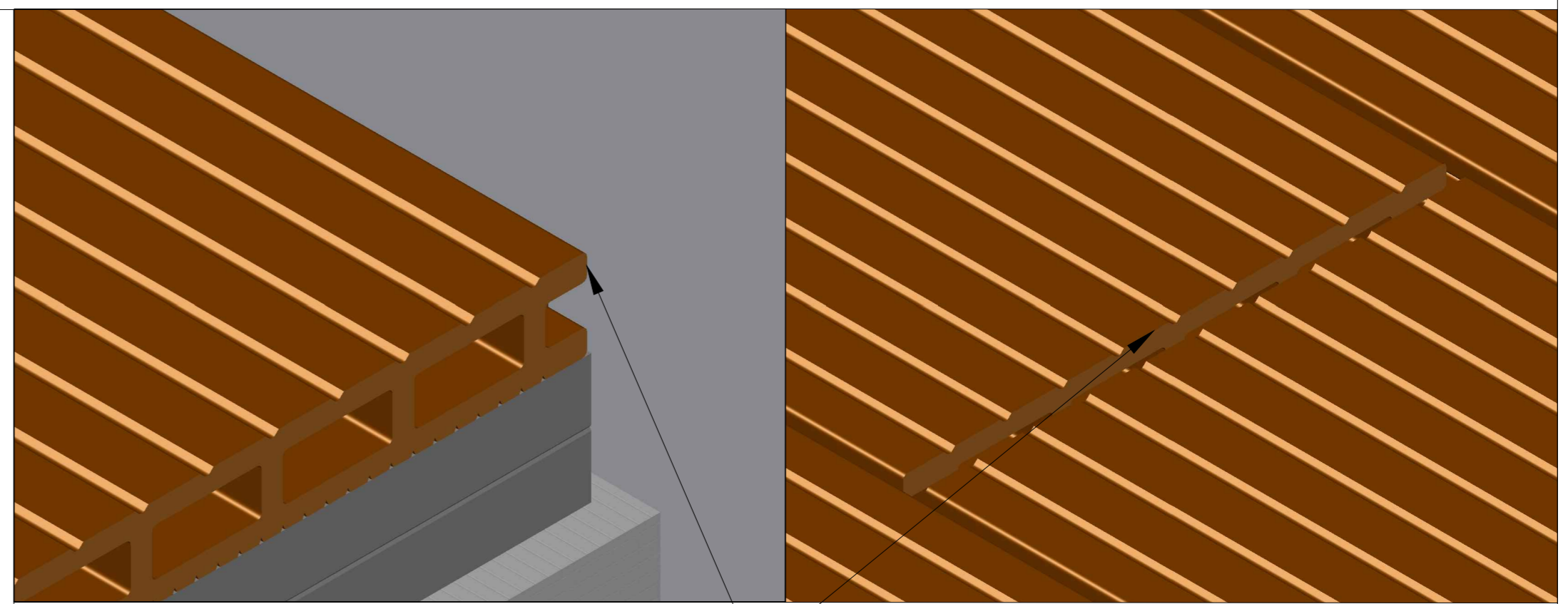
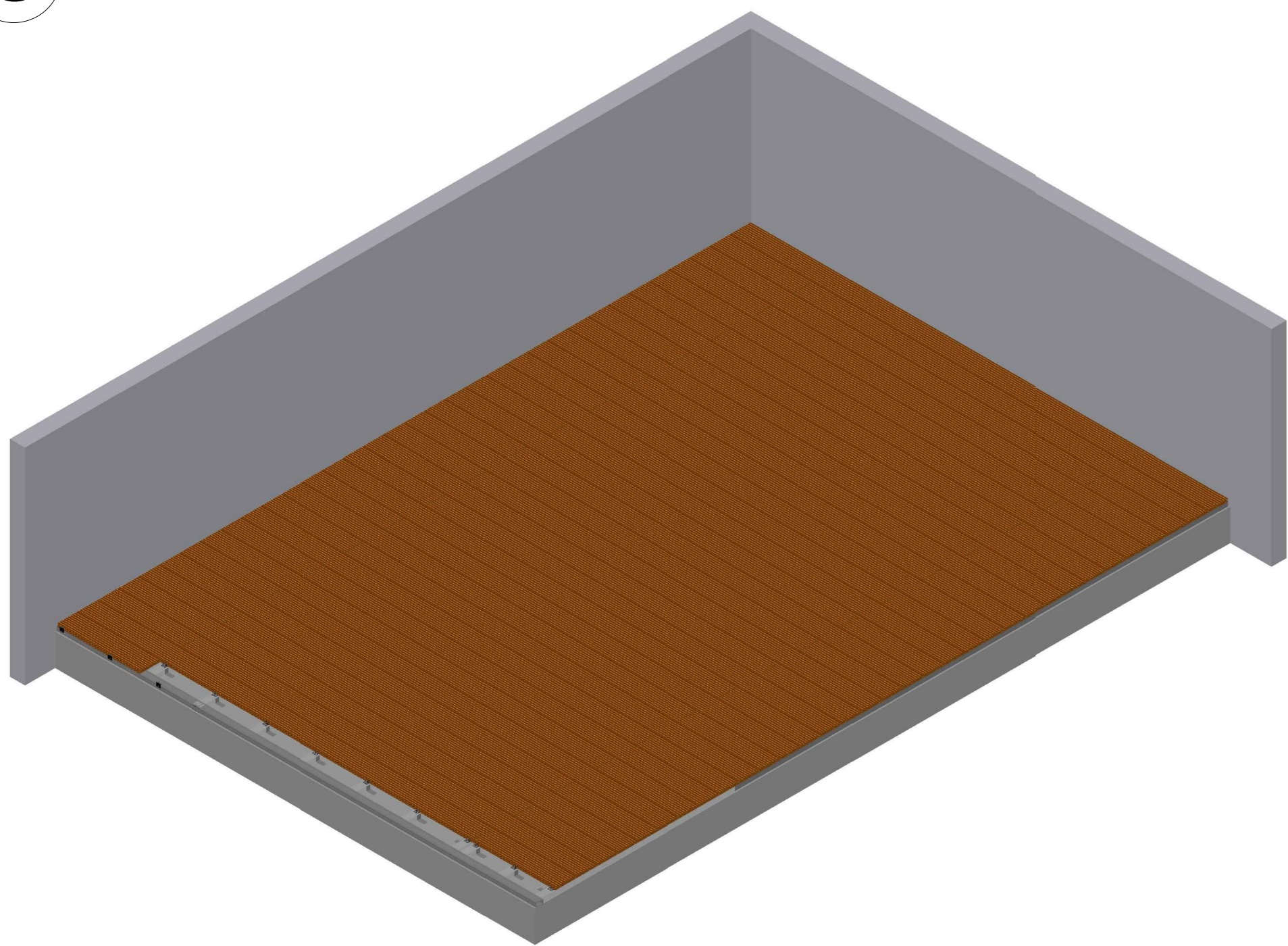

EXPANSION GAPS AND END CLIPS FIXING DETAIL. MAKE SURE TO ALWAYS LEAVE 6-8 MM EXPANSION GAPS FROM WALLS, COPING, PLANTERS OR ANY VERTICAL STRUCTURE ON THE SIDES OF THE DECK. THE SAME GAPS SHOULD BE MAINTAINED BETWEEN THE LATERAL JOINTS OF PLANKS. THE LARGER THE DECK, THE LARGER THE EXPANSION GAPS TO BE MAINTAINED TO ALLOW FOR EXPANSION. PLACE THE END CLIPS AND SCREW TO THE END JOIST AS SHOWN IN THE DIAGRAM TO SECURE THE LAST BOARD. IF THE LAST BOARD IS NOT TO FULL WIDTH, TRIM THE BOARD TO THE OUTER PLANE OF THE JOIST AND CROSS SCREW INTO THE JOIST TO SECURE.

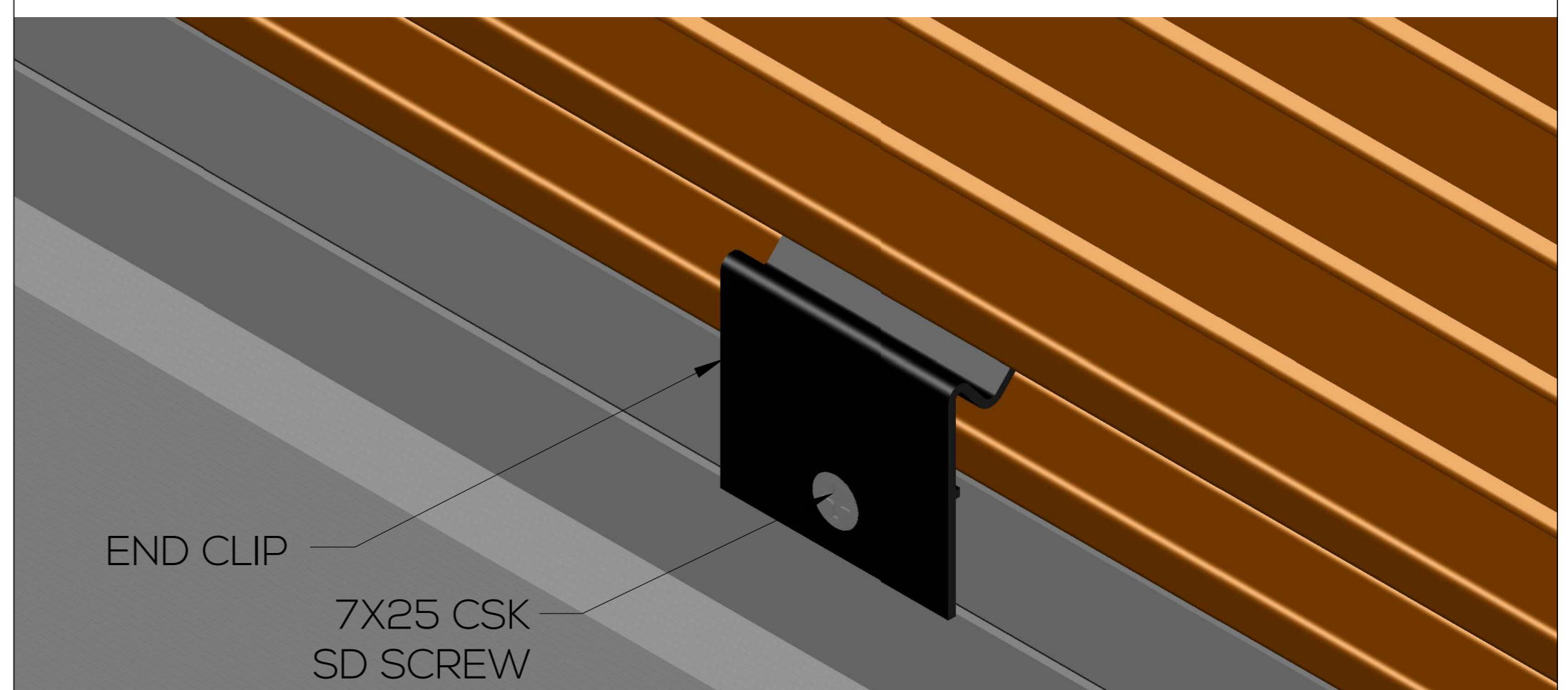

## SIDE TRIM FIXING DETAIL

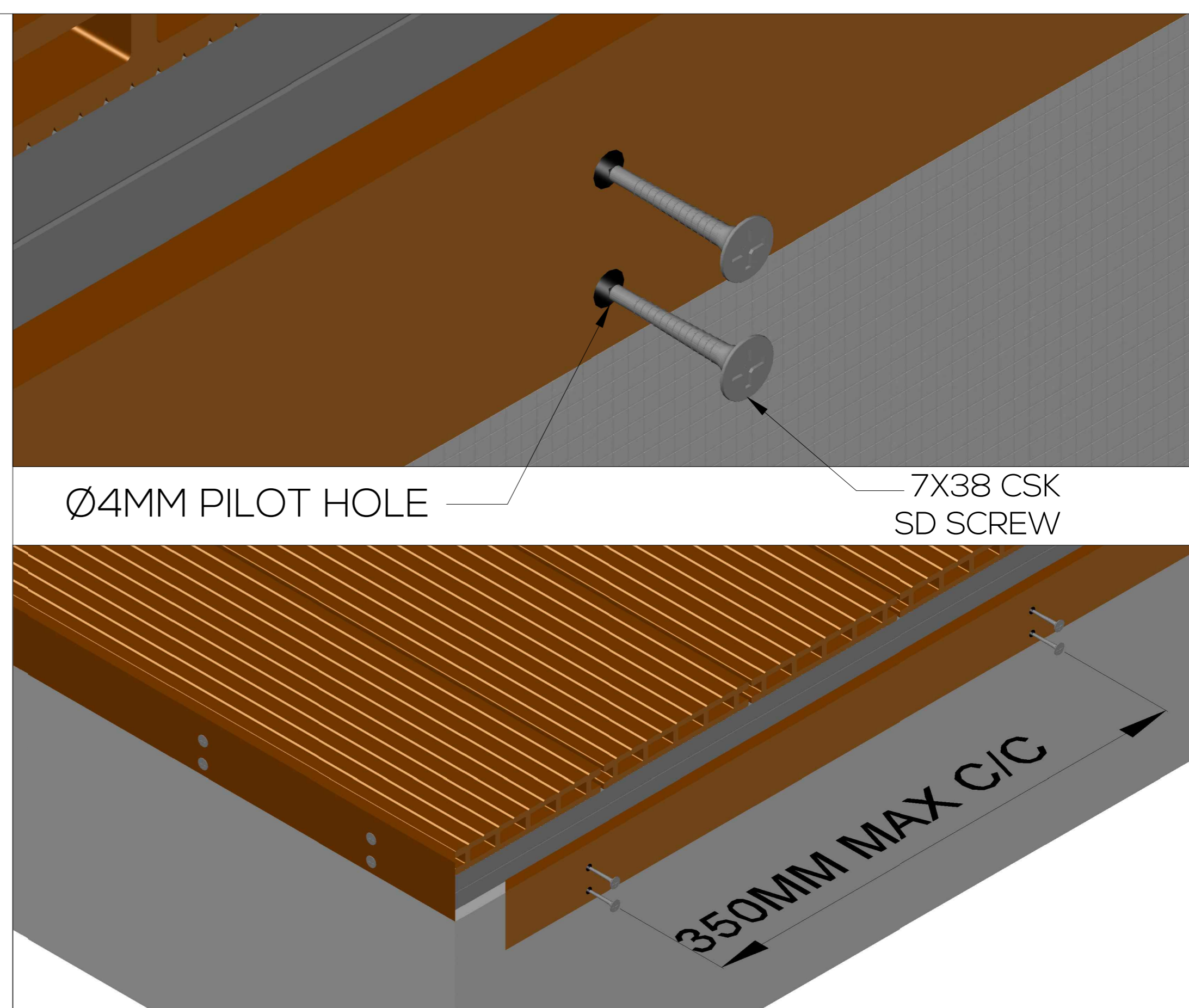
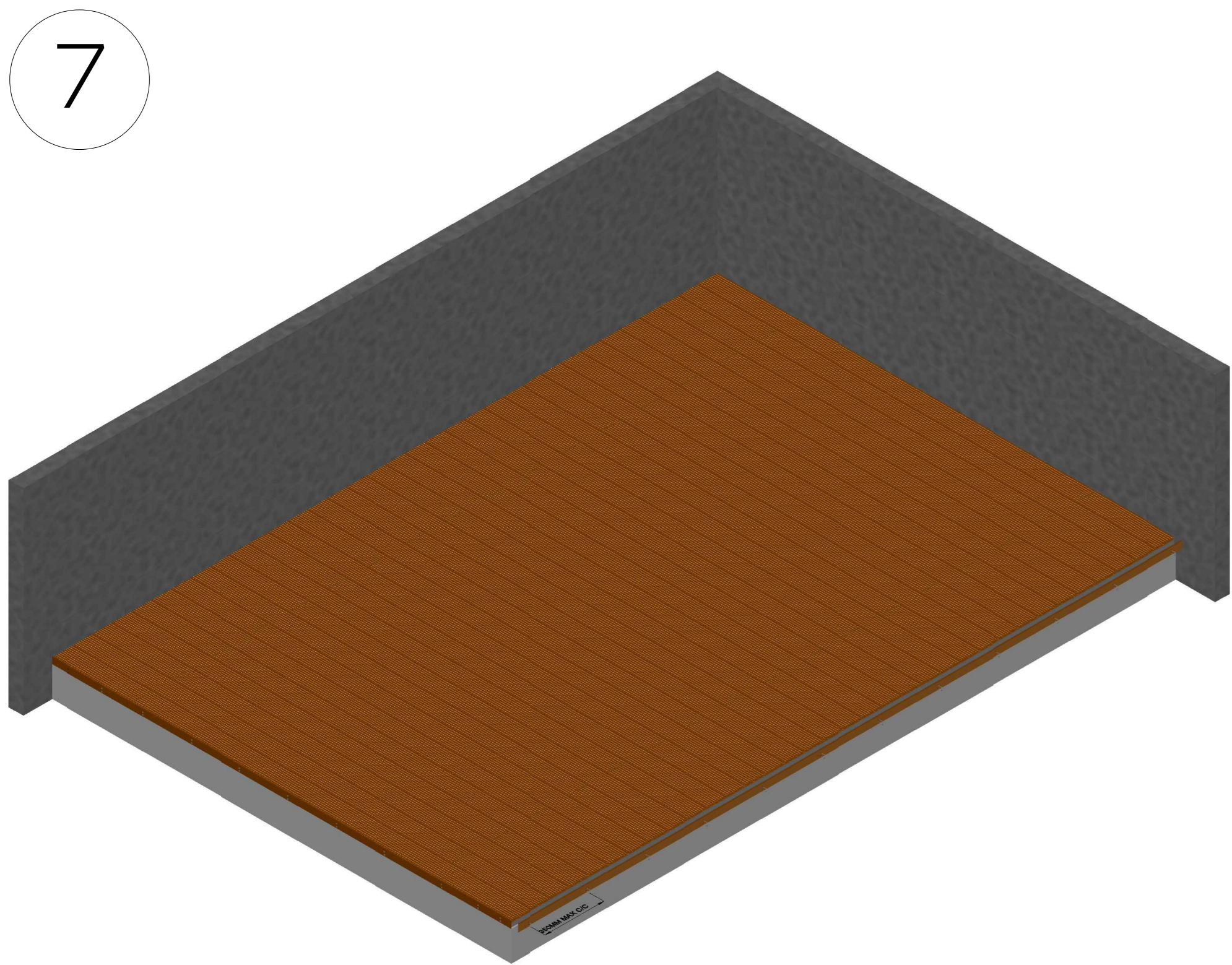

ONCE THE LAST BOARD HAS BEEN FITTED EITHER WITH THE END CLIP OR THE CROSS SCREWS TO SECURE TO THE JOIST FRAMEWORK, FINISH THE DECK SIDES WITH 57X10 TRIMS SECURED TO THE LAST JOISTS WITH 10X38MM SELF TAPPING SCREWS AT INTERVALS NOT EXCEEDING 400 MM. MITER CUT TRIMS AT CORNERS USING SCREWS NOT MORE THAN 50MM FROM THE CORNERS.

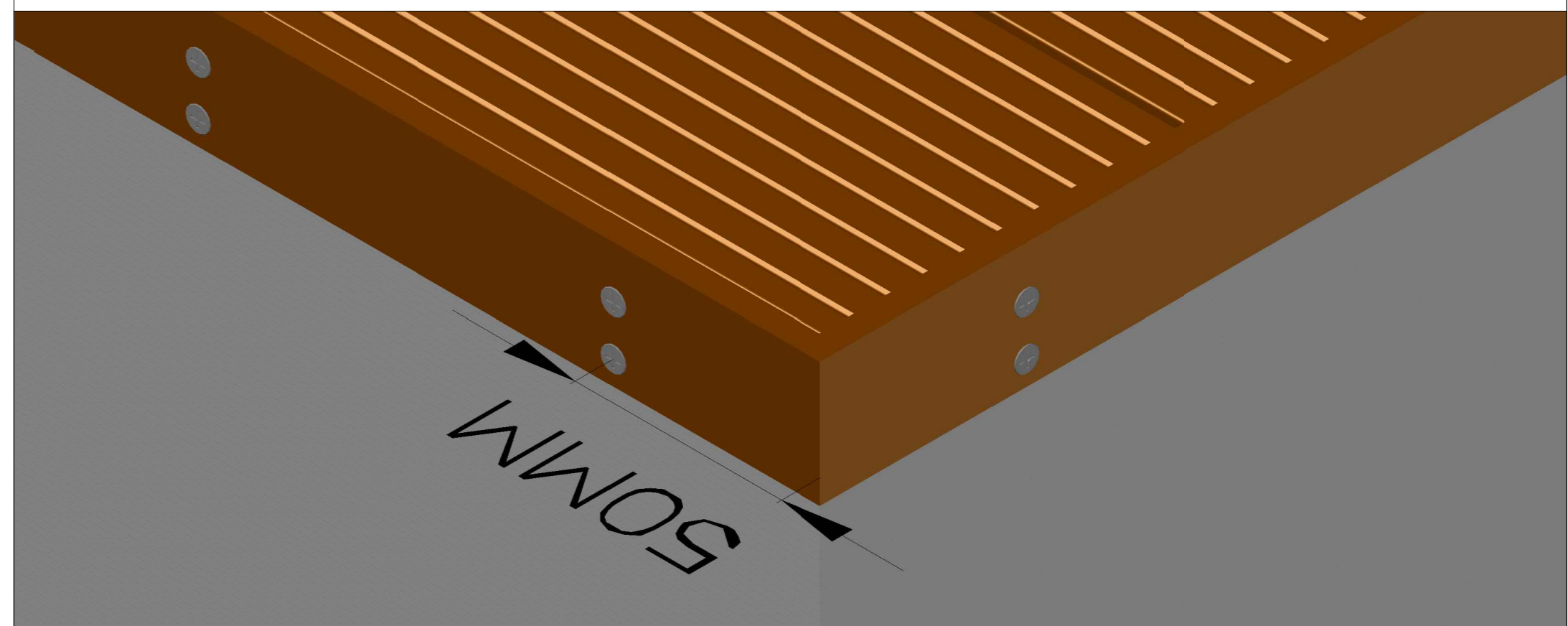

### DO'S

1. HAVING TAKEN DELIVERY OF YOUR BOARDS / PROFILES, WE RECOMMEND YOU ALLOW THEM A DAY TO ADJUST TO THE EXTERIOR AMBIENT TEMPERATURE AND CONDITIONS BEFORE STARTING WORK.
2. YOUR COMPOSITE BOARDS AND PROFILES CAN BE WORKED WITH NORMAL WOODWORKING TOOLS AND RECOMMEND USING A WOOD SAW WITH A FINE-TOOTH BLADE TO CUT BOARDS TO SIZE.
3. WHEN CUTTING, CARE SHOULD BE TAKEN TO ENSURE THE BOARDS ARE PROPERLY SUPPORTED.
4. ALWAYS FINISH BURRS OR UNFINISHED CUT EDGES WITH SAND PAPER TO SMOOTHEN SURFACES AND EDGES.
5. WPC EXPANDS AND CONTRACTS WITH TEMPERATURE CHANGE. PLEASE ENSURE TO MAINTAIN 6-8 MM GAPS FROM FLOORS WALLS, CEILING AND BETWEEN PANELS TO ALLOW FOR DIMENSIONAL CHANGES.
6. ALWAYS USE ANTI-CORROSIVE HARDWARES, FIXTURES AND FASTNERS WHILE INSTALLING YOUR WPC.

### DONT'S

1. WE DO NOT RECOMMEND INSTALLING WPC IN VERY HOT OR COLD WEATHER. DO NOT USE CHISELS OR OTHER SHARP TOOLS THAT REQUIRE IMPACT WHILE WORKING WITH WPC, ALWAYS USE A SAW.
2. DO NOT USE NAILS TO FASTEN WPC. ALWAYS USE SELF DRILLING SCREWS.
3. NEVER OVERTIGHTEN FASTNERS OR SCREWS WHILE INSTALLING WPC.
4. DO NOT USE STRONG CORROSIVE CHEMICALS OR BLEACH TO CLEAN WPC.